



Ovens

ADVANCE ovens

ADVANCE OVEN, AE-101

DIMENSIONS

		Article	Packed
Length	mm	898,00	1.100,00
Depth	mm	867,00	1.000,00
Height	mm	1.117,00	1.270,00
Weigth	Kg	169,00	224,00
Volumen	m3	0,87	1,54

ELECTRICITY

Electric power	KW	
230V -1+N		19,20
230V - III		3x10+T - 63 A
400V - III+N		4x6+T - 32 A

WATER

Water consumption (lit/h)	40,00
Pressure (Kg/cm2)	2 - 4

GAS

Not used

STEAM

Not used

AIR

Not used

LEVEL SOUND

(dB) 62,00

ELECTRIC ADVANCE COMBI OVEN, AE-101

High quality, fast cooking :

- Professional quality
- Easy to use and efficient
- Perfect results
- Affordable

Capacity for 10 1/1-GN trays.

Push-button and "Scrolling" controls.

5 cooking methods: Steam, Low-temperature steam, Regeneration, Combination and Convection (up to 300°C).

Preheating option.

Overnight cooking or low-temperature programme.

3 Speeds - 2 power ranges.

Cold-Down chamber cooling system.

"Auto-reverse" system to reverse fan rotation.

Electronic temperature probe.

Steam generator equipped with limescale detector.

Steam generator automatically empties every 24 hours of cooking.

Semi-automatic limescale removal system.

Error detection system. "Repair service" mode system.

IPX-5 protection.

AUTOMATIC CLEANING - Wash program for the cooking chamber.

Retractable shower.

Quick door closing system. Double glass.

Electric power: 19,20 kW.

Dimensions: 898 x 922 x 1.117 mm.

Accessories in option:

- Support SH-11
- Structure for trays EB-101
- Structure for dishes EP-101
- Loading trolley CP-11

Connections points	X	Y	Z	Diameter	Information
ELECTRICITY	742	620	110		Prever Interruptor diferencial 300 mA
COLD WATER	825	482	110	3/4"	Prever llave de corte en la toma
DRAIN	467	237	110	30x25	Pendiente del 5%
SOFT COLD WATER	825	557	110	3/4"	Prever llave de corte en la toma

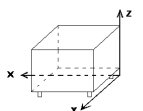

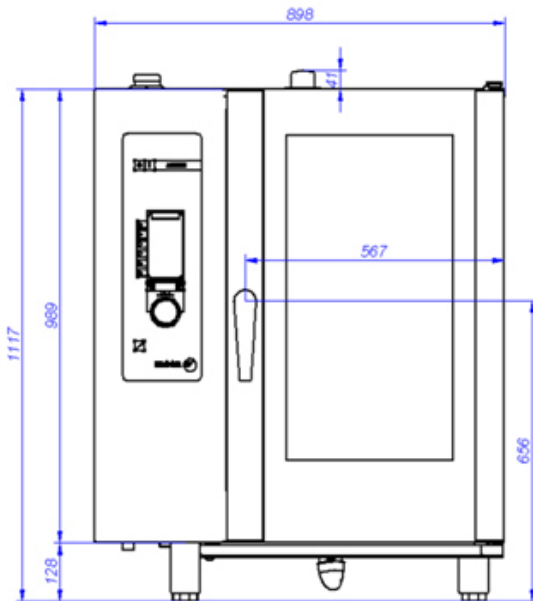

AE-101

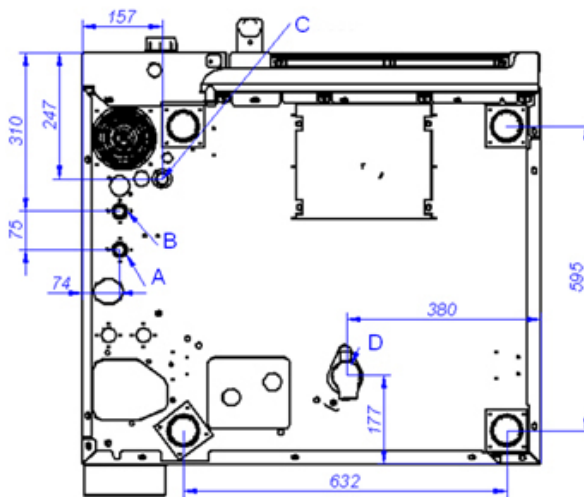

VISTA DE LA BASE DESDE LA PARTE INFERIOR
VIEW FROM THE BOTTOM OF THE MACHINE

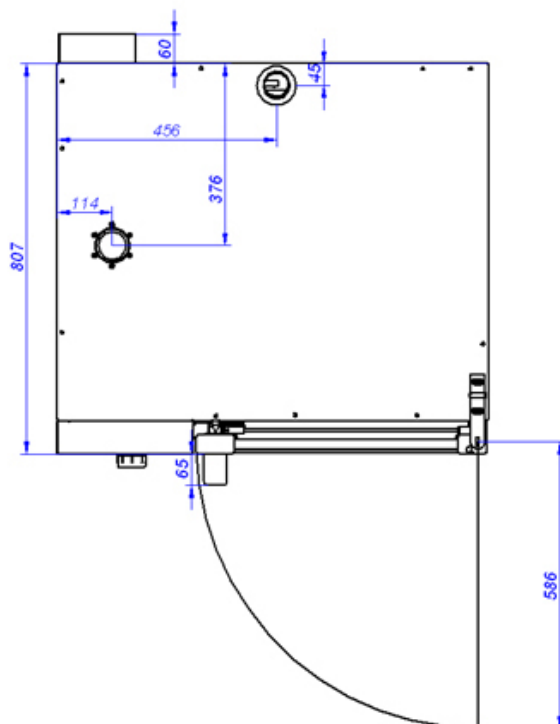

- A: Entrada de agua blanda
- B: Entrada de agua dura
- D: Desagüe

C: Alimentación eléctrica

- A: Soft water inlet
- B: Water inlet
- D: Drain

C: Electrical connection