



Catalogue :

CABINETS GLOBE

Chapter :

GLOBE CONCEPT GN CABINETS

Article :

EAFP-801 230V 1N 50Hz

Code:

19037764

<u>DIMENSIONS AND WEIGHTS</u>		<u>Net dimensions</u>	<u>Packed</u>
Length	mm	653,00	860,00
Depth	mm	842,00	730,00
Height	mm	2.040,00	2.063,00
Weight	kg	153,00	160,00
Volume	m3	1,09	1,30
<u>ELECTRICITY</u>		50Hz	
	Power		0,18 kW
Connections	230 V. 1+N+T	2X1,5+T - 4 A	
	230 V. III+T	OPC3X4+T-32A	
	400 V. III+N+T	4X1,5+T - 16 A	
<u>GAS</u>	Not necessary		
<u>WATER</u>	Not necessary		
<u>STEAM</u>	Not necessary		
<u>AIR</u>	Not necessary		
			R-600a
	Refrigeration power		0,309
	Consumption - kW-h	365 d.	548
		24 h	1,50
	Net volume - litres	Refrig.	461
	Internal gross capacity	litres	610
	Climat class	4	Energy Effic. C
<u>SOUND LEVEL</u>	< 65,00 db		
<u>CERTIFICATES</u>	SGS-2103-0906-1		
<u>INSTALLATION - CONNECTIONS</u>	Ø		
	► ELECTRICITY		SI

DESCRIPTION

REFRIGERATED CABINET GASTRONORM, EAFP-801

SPECIFICATIONS

High quality austenitic stainless steel inside and outside (except for galvanized back panel).
 60 mm, 40 kg/m3 injected polyurethane isolation.
 Embedded inner tray slides. Storage trays at 23 different levels 55 mm from each other.
 Forced draught cooling system with hermetically sealed compressor.
 Copper piping and aluminium flaps evaporator.
 Digital display for electronic and digital control of temperature and defrosting.
 Opened door delay alarm.
 Self-closing and stay open doors. When opened less than 90° they close by themselves. When opened more than 135° they stay open.
 Built in drainage to get rid of waste liquids inside the unit.
 Embedded bottom and curved panels inside for easy cleaning and maintenance.
 Removable plastic covered steel grid shelves for easy cleaning.
 Equipment: 3 shelves per large door.
 Height adjustable stainless steel legs.
 Working temperature: from -2 °C up to +8 °C.
 Climatic class 4.
 Inner LED lights with power switch.

Doors: 1
 Energy efficiency: C
 Net capacity: 461 L
 Gross capacity: 610 L
 Cooling power: 310 W
 Electric power: 160 W
 Annual energy consumption: 548 kWh/year
 Coolant: R-600a
 Dimensions: 653x842x2040 mm





Catalogue :
CABINETS GLOBE

Chapter :
GLOBE CONCEPT GN CABINETS

Article :
EAFP-801 230V 1N 50Hz

Code :
19037764

SCHEMA - DIMENSIONS

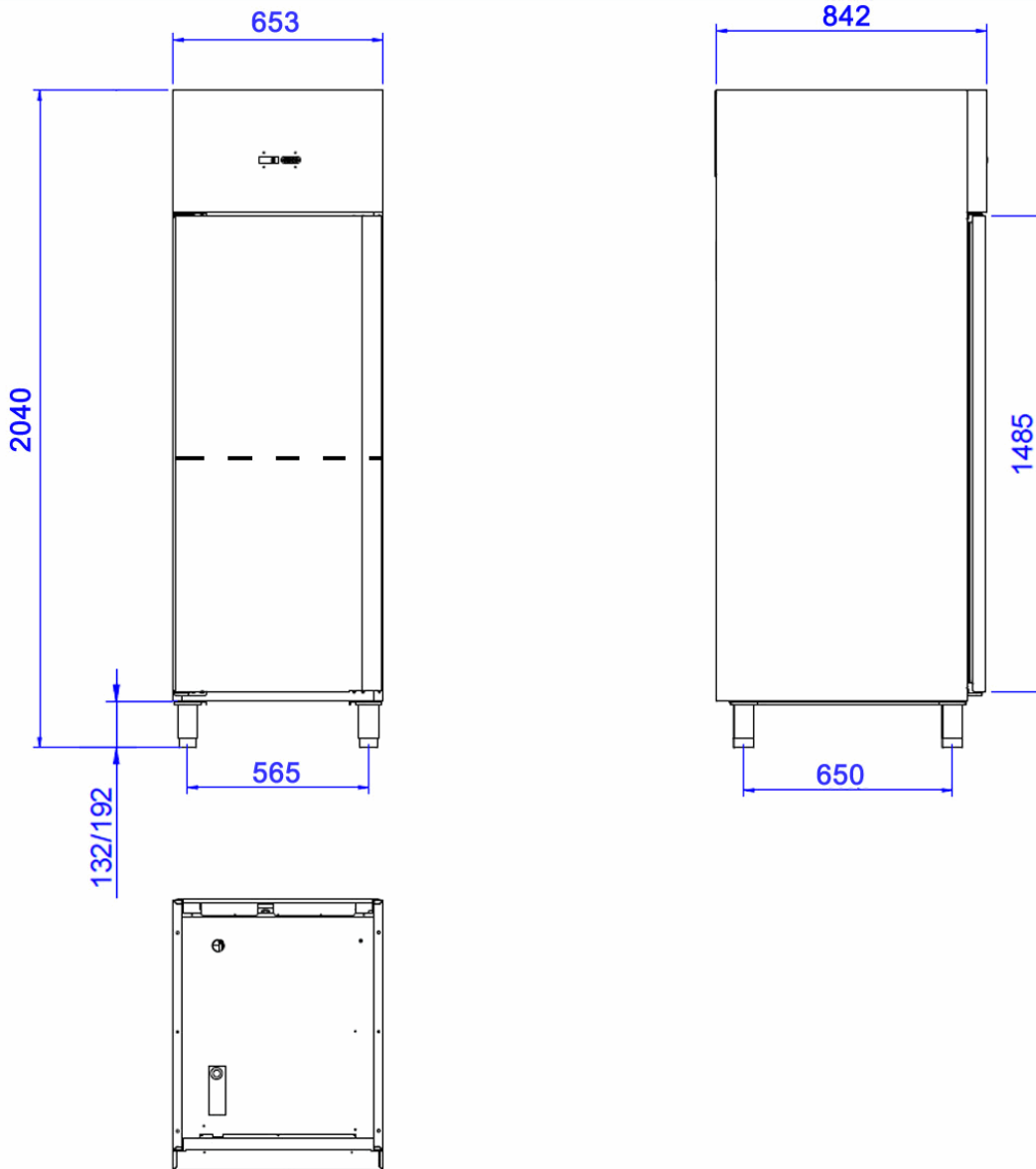



Catalogue :

CABINETS GLOBE

Chapter :

GLOBE CONCEPT GN CABINETS

Article :

EAFP-802 230V 1N 50Hz

Code:

19037772

<u>DIMENSIONS AND WEIGHTS</u>		<u>Net dimensions</u>	<u>Packed</u>
Length	mm	653,00	860,00
Depth	mm	842,00	730,00
Height	mm	2.040,00	2.063,00
Weight	kg	153,00	160,00
Volume	m3	1,09	1,30
<u>ELECTRICITY</u>		50Hz	
	Power		0,18 kW
Connections	230 V. 1+N+T	2X1,5+T - 4 A	
	230 V. III+T	OPC3X4+T-32A	
	400 V. III+N+T	4X1,5+T - 16 A	
<u>GAS</u>	Not necessary		
<u>WATER</u>	Not necessary		
<u>STEAM</u>	Not necessary		
<u>AIR</u>	Not necessary		
			R-600a
	Refrigeration power		0,309
	Consumption - kW-h	365 d.	548
		24 h	1,50
	Net volume - litres	Refrig.	461
	Internal gross capacity	litres	610
	Climat class	4	Energy Effic. C
<u>SOUND LEVEL</u>	< 65,00 db		
<u>CERTIFICATES</u>	SGS-2103-0906-1		
<u>INSTALLATION - CONNECTIONS</u>	Ø		
	► ELECTRICITY		SI

DESCRIPTION

REFRIGERATED CABINET GASTRONORM, EAFP-802

SPECIFICATIONS

High quality austenitic stainless steel inside and outside (except for galvanized back panel).
 60 mm, 40 kg/m3 injected polyurethane isolation.
 Embedded inner tray slides. Storage trays at 23 different levels 55 mm from each other.
 Forced draught cooling system with hermetically sealed compressor.
 Copper piping and aluminium flaps evaporator.
 Digital display for electronic and digital control of temperature and defrosting.
 Opened door delay alarm.
 Self-closing and stay open doors. When opened less than 90° they close by themselves. When opened more than 135° they stay open.
 Built in drainage to get rid of waste liquids inside the unit.
 Embedded bottom and curved panels inside for easy cleaning and maintenance.
 Removable plastic covered steel grid shelves for easy cleaning.
 Equipment: 3 shelves per large door.
 Height adjustable stainless steel legs.
 Working temperature: from -2 °C up to +8 °C.
 Climatic class 4.
 Inner LED lights with power switch.

Doors: 2
 Energy efficiency: C
 Net capacity: 461 L
 Gross capacity: 610 L
 Cooling power: 310 W
 Electric power: 160 W
 Annual energy consumption: 548 kWh/year
 Coolant: R-600a
 Dimensions: 653x842x2040 mm





Catalogue :
CABINETS GLOBE

Chapter :
GLOBE CONCEPT GN CABINETS

Article :
EAFP-802 230V 1N 50Hz

Code :
1903772

SCHEMA - DIMENSIONS

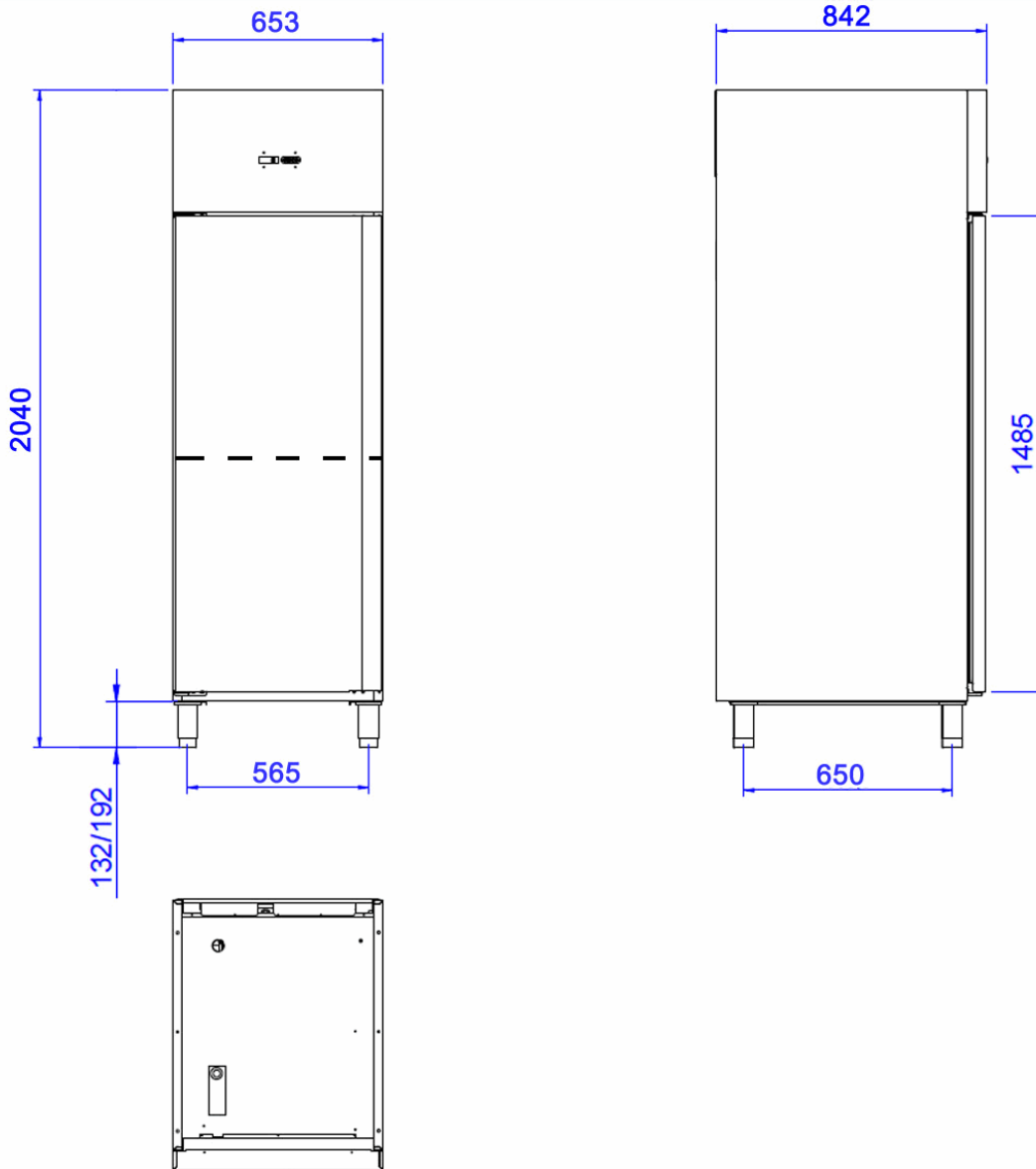



Catalogue :

CABINETS GLOBE

Chapter :

GLOBE CONCEPT GN CABINETS

Article :

EAEP-801 230V 1N 50Hz

Code:

19037812

<u>DIMENSIONS AND WEIGHTS</u>		<u>Net dimensions</u>	<u>Packed</u>
Length	mm	653,00	860,00
Depth	mm	842,00	730,00
Height	mm	2.040,00	2.063,00
Weight	kg	142,00	149,00
Volume	m3	1,09	1,30
<u>ELECTRICITY</u>		50Hz	
	Power		0,18 kW
Connections	230 V. 1+N+T	2X1,5+T - 4 A	
	230 V. III+T		
	400 V. III+N+T	2X(4X6MM2+T)	
<u>GAS</u>	Not necessary		
<u>WATER</u>	Not necessary		
<u>STEAM</u>	Not necessary		
<u>AIR</u>	Not necessary		
			R-600a
	Refrigeration power		0,309
	Internal gross capacity litres		610
	Climat class	4	
<u>SOUND LEVEL</u>			< 65,00 db
<u>CERTIFICATES</u>	SGS-2103-0906-1		
<u>INSTALLATION - CONNECTIONS</u>			Ø
	▶ ELECTRICITY	SI	

DESCRIPTION

REFRIGERATED DISPLAY CABINET GASTRONORM, EAEP-801

SPECIFICATIONS

High quality austenitic stainless steel inside and outside (except for galvanized back panel).
 60 mm, 40 kg/m3 injected polyurethane isolation.
 Embedded inner tray slides. Storage trays at 23 different levels 55 mm from each other.
 Forced draught cooling system with hermetically sealed compressor.
 Copper piping and aluminium flaps evaporator.
 Digital display for electronic and digital control of temperature and defrosting.
 Opened door delay alarm.
 Self-closing and stay open doors. When opened less than 90° they close by themselves. When opened more than 135° they stay open.
 Built in drainage to get rid of waste liquids inside the unit.
 Embedded bottom and curved panels inside for easy cleaning and maintenance.
 Removable plastic covered steel grid shelves for easy cleaning.
 Equipment: 3 shelves per large door.
 Height adjustable stainless steel legs.
 Working temperature: from -2 °C up to +8 °C.
 Climatic class 4.
 Double pane door and anodised aluminium frame with double vacuum chamber.
 Inner LED lights with power switch.

Doors: 1
 Gross capacity: 610 L
 Cooling power: 310 W
 Electric power: 160 W
 Coolant: R-600a
 Dimensions: 653x842x2040 mm





Catalogue :
CABINETS GLOBE

Chapter :
GLOBE CONCEPT GN CABINETS

Article :
EAEP-801 230V 1N 50Hz

Code :
19037812

SCHEMA - DIMENSIONS

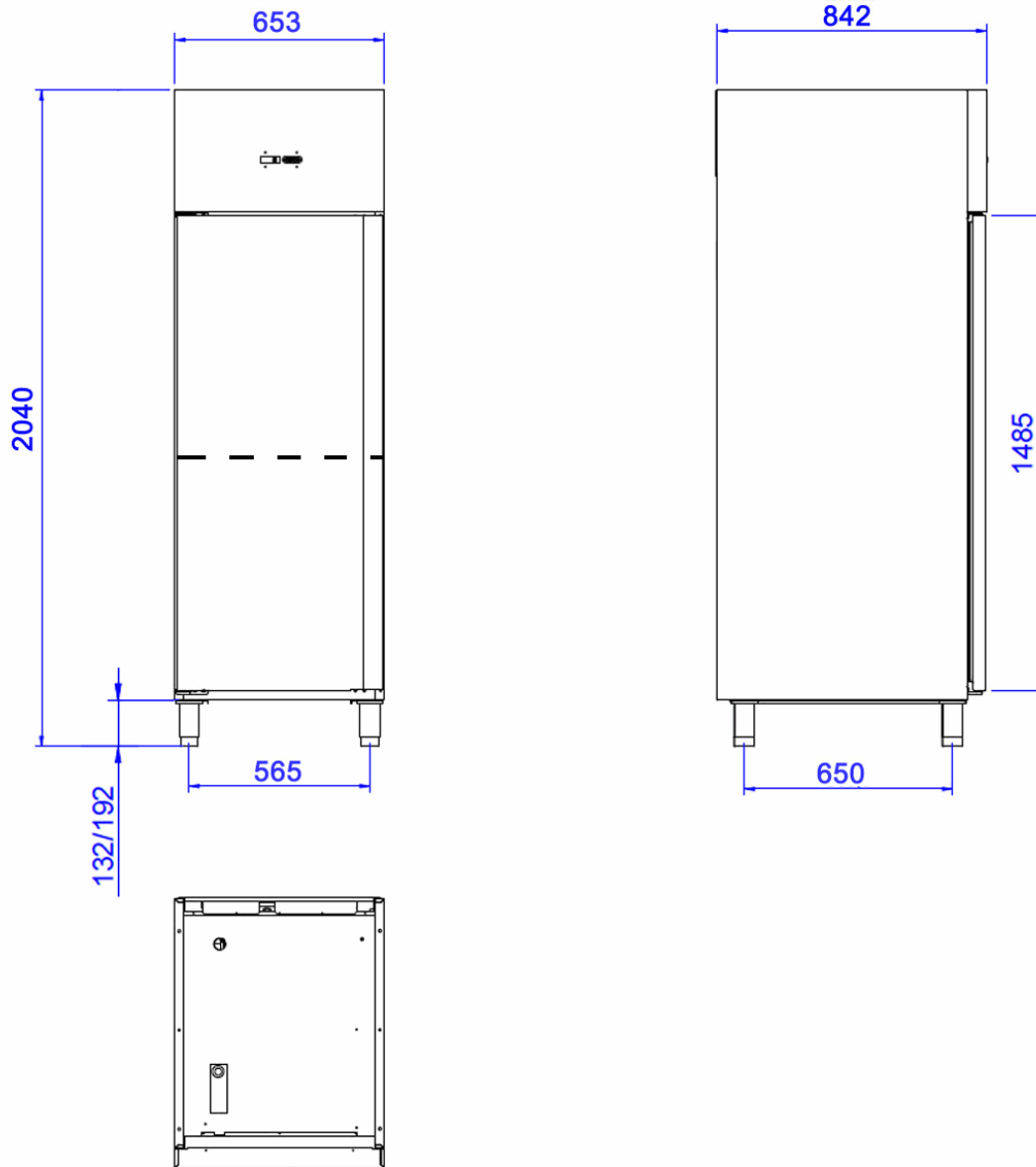



Catalogue :

CABINETS GLOBE

Chapter :

GLOBE CONCEPT GN CABINETS

Article :

EAEP-802 230V 1N 50Hz

Code:

19037813

<u>DIMENSIONS AND WEIGHTS</u>		<u>Net dimensions</u>	<u>Packed</u>
Length	mm	653,00	860,00
Depth	mm	842,00	730,00
Height	mm	2.040,00	2.063,00
Weight	kg	153,00	160,00
Volume	m3	1,12	1,30
<u>ELECTRICITY</u>		50Hz	
	Power		0,18 kW
Connections	230 V. 1+N+T	2X1,5+T - 4 A	
	230 V. III+T		
	400 V. III+N+T	2X(4X6MM2+T)	
<u>GAS</u>	Not necessary		
<u>WATER</u>	Not necessary		
<u>STEAM</u>	Not necessary		
<u>AIR</u>	Not necessary		
			R-600a
	Refrigeration power		0,309
	Internal gross capacity litres		610
	Climat class	4	
<u>SOUND LEVEL</u>			< 65,00 db
<u>CERTIFICATES</u>	SGS-2103-0906-1		
<u>INSTALLATION - CONNECTIONS</u>			Ø
	▶ ELECTRICITY	SI	

DESCRIPTION

REFRIGERATED DISPLAY CABINET GASTRONORM, EAEP-802

SPECIFICATIONS

High quality austenitic stainless steel inside and outside (except for galvanized back panel).
 60 mm, 40 kg/m3 injected polyurethane isolation.
 Embedded inner tray slides. Storage trays at 23 different levels 55 mm from each other.
 Forced draught cooling system with hermetically sealed compressor.
 Copper piping and aluminium flaps evaporator.
 Digital display for electronic and digital control of temperature and defrosting.
 Opened door delay alarm.
 Self-closing and stay open doors. When opened less than 90° they close by themselves. When opened more than 135° they stay open.
 Built in drainage to get rid of waste liquids inside the unit.
 Embedded bottom and curved panels inside for easy cleaning and maintenance.
 Removable plastic covered steel grid shelves for easy cleaning.
 Equipment: 3 shelves per large door.
 Height adjustable stainless steel legs.
 Working temperature: from -2 °C up to +8 °C.
 Climatic class 4.
 Double pane door and anodised aluminium frame with double vacuum chamber.
 Inner LED lights with power switch.

Doors: 2
 Gross capacity: 610 L
 Cooling power: 310 W
 Electric power: 160 W
 Coolant: R-600a
 Dimensions: 653x842x2040 mm





Catalogue :
CABINETS GLOBE

Chapter :
GLOBE CONCEPT GN CABINETS

Article :
EAEP-802 230V 1N 50Hz

Code :
19037813

SCHEMA - DIMENSIONS

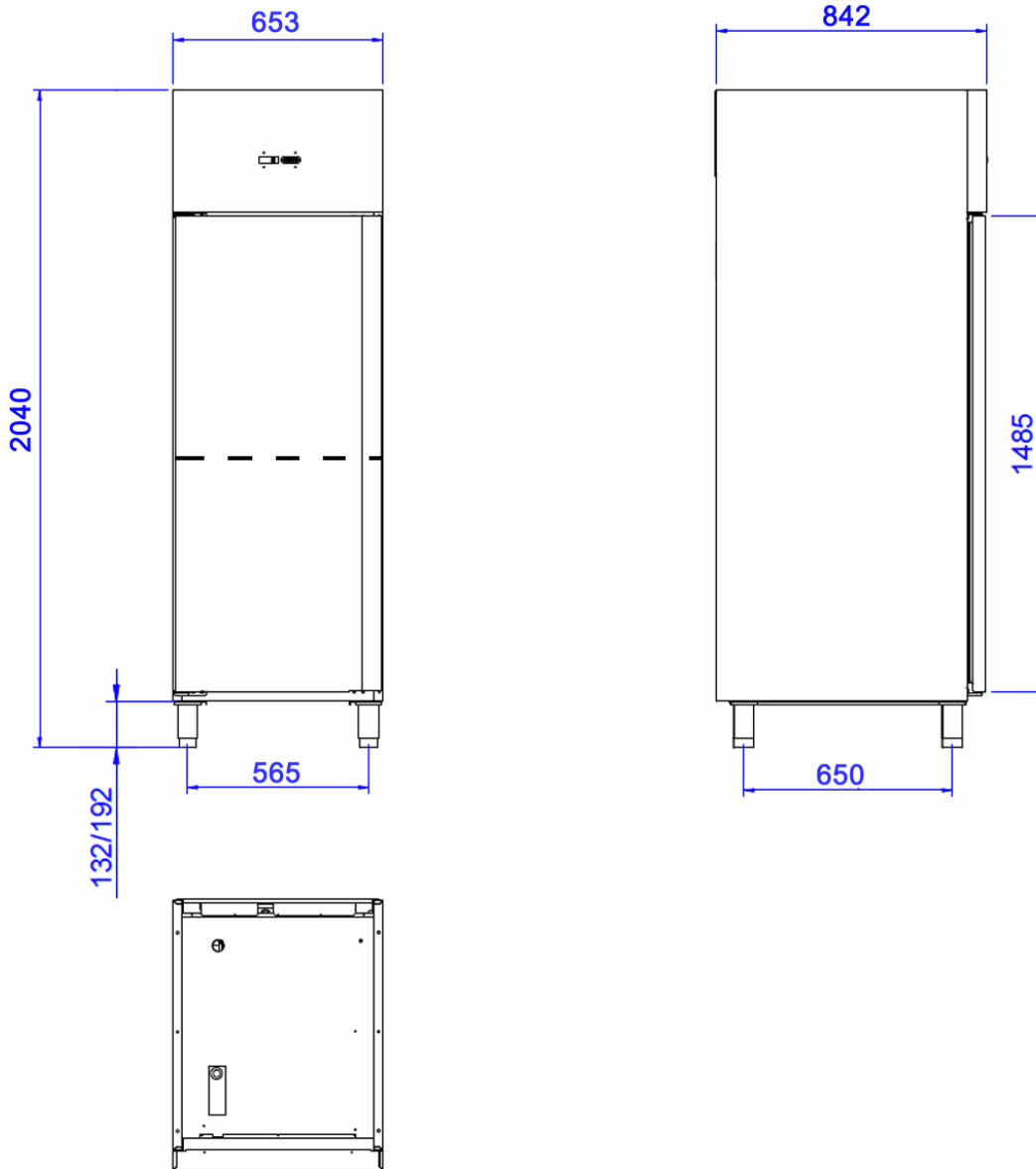



Catalogue :

CABINETS GLOBE

Chapter :

GLOBE CONCEPT GN CABINETS

Article :

EAFP-1602 230V 1N 50Hz

Code:

19037832

<u>DIMENSIONS AND WEIGHTS</u>		<u>Net dimensions</u>	<u>Packed</u>
Length	mm	1.318,00	860,00
Depth	mm	842,00	1.430,00
Height	mm	2.040,00	2.063,00
Weight	kg	217,00	230,00
Volume	m3	2,20	2,54
<u>ELECTRICITY</u>		50Hz	
	Power		0,21 kW
Connections	230 V. 1+N+T	2X1,5+T - 4 A	
	230 V. III+T	OPC3X4+T-32A	
	400 V. III+N+T	4X4MM2+T	
<u>GAS</u>	Not necessary		
<u>WATER</u>	Not necessary		
<u>STEAM</u>	Not necessary		
<u>AIR</u>	Not necessary		
			R-600a
	Refrigeration power		0,357
	Consumption - kW-h	365 d.	913
		24 h	2,50
	Net volume - litres	Refrig.	922
	Internal gross capacity	litres	1.332
	Climat class	4	Energy Effic. C
<u>SOUND LEVEL</u>	< 65,00 db		
<u>CERTIFICATES</u>	SGS-2103-0906-1		
<u>INSTALLATION - CONNECTIONS</u>	Ø		
	► ELECTRICITY		SI

DESCRIPTION

REFRIGERATED CABINET GASTRONORM, EAFP-1602

SPECIFICATIONS

High quality austenitic stainless steel inside and outside (except for galvanized back panel).
 60 mm, 40 kg/m3 injected polyurethane isolation.
 Embedded inner tray slides. Storage trays at 23 different levels 55 mm from each other.
 Forced draught cooling system with hermetically sealed compressor. Copper piping and aluminium flaps evaporator.
 Digital display for electronic and digital control of temperature and defrosting.
 Opened door delay alarm.
 Self-closing and stay open doors. When opened less than 90° they close by themselves. When opened more than 135° they stay open.
 Built in drainage to get rid of waste liquids inside the unit.
 Embedded bottom and curved panels inside for easy cleaning and maintenance.
 Removable plastic covered steel grid shelves for easy cleaning.
 Equipment: 3 shelves per large door.
 Height adjustable stainless steel legs.
 Working temperature: from -2 °C up to +8 °C.
 Climatic class 4.
 Inner LED lights with power switch.

Doors: 2
 Energy efficiency: C
 Net capacity: 922 L
 Gross capacity: 1332 L
 Cooling power: 360 W
 Electric power: 180 W
 Annual energy consumption: 913 kWh/year
 Coolant: R-600a
 Dimensions: 1318x842x2040 mm





Catalogue :
CABINETS GLOBE

Chapter :
GLOBE CONCEPT GN CABINETS

Article :
EAFP-1602 230V 1N 50Hz

Code :
19037832

SCHEMA - DIMENSIONS

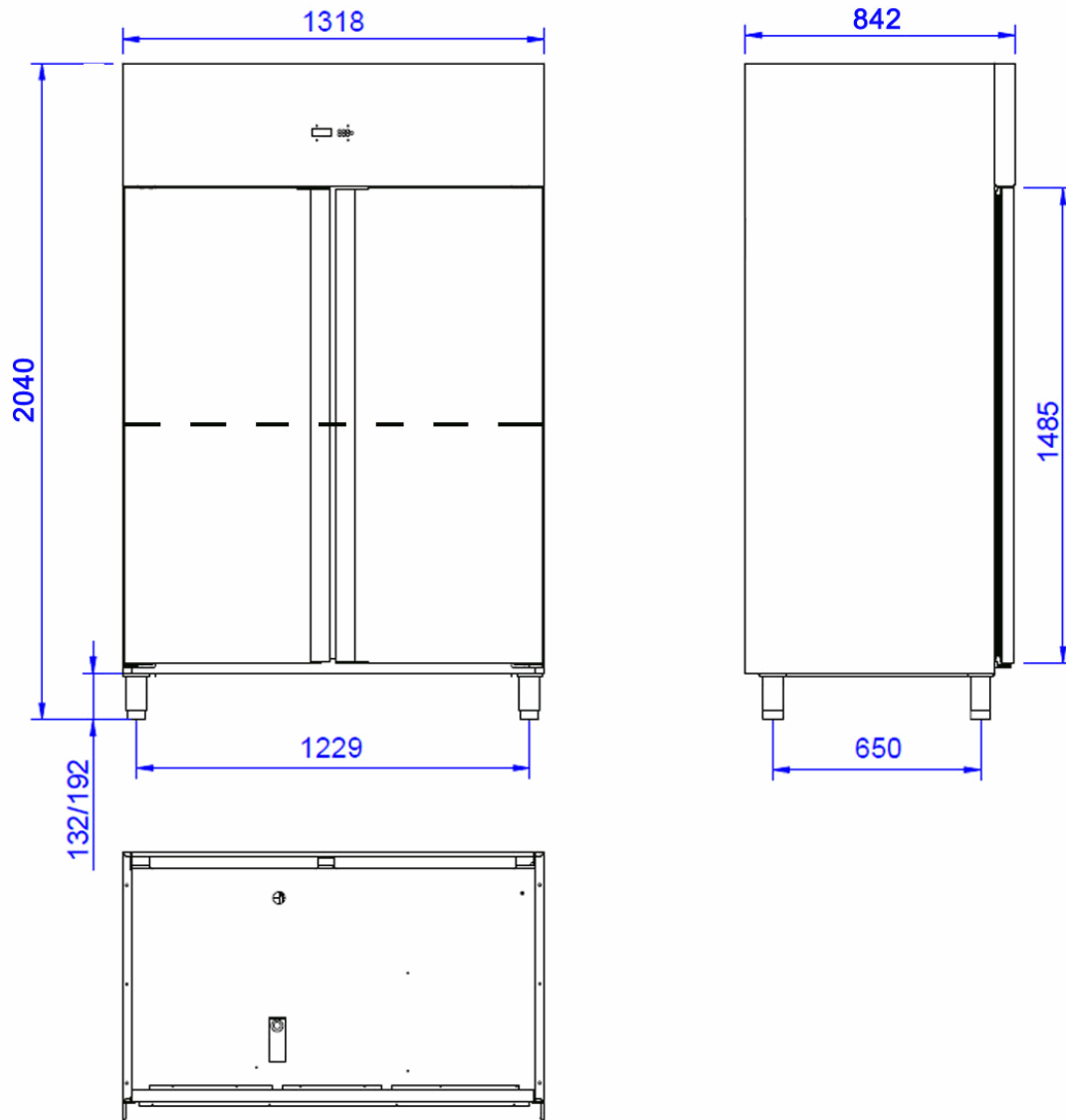



Catalogue :

CABINETS GLOBE

Chapter :

GLOBE CONCEPT GN CABINETS

Article :

EAFP-1603 230V 1N 50Hz

Code:

19037834

<u>DIMENSIONS AND WEIGHTS</u>		<u>Net dimensions</u>	<u>Packed</u>
Length	mm	1.318,00	860,00
Depth	mm	842,00	1.430,00
Height	mm	2.040,00	2.063,00
Weight	kg	225,00	230,00
Volume	m3	2,26	2,54
<u>ELECTRICITY</u>		50Hz	
	Power		0,21 kW
Connections	230 V. 1+N+T	2X1,5+T - 4 A	
	230 V. III+T	OPC3X4+T-32A	
	400 V. III+N+T	4X4MM2+T	
<u>GAS</u>	Not necessary		
<u>WATER</u>	Not necessary		
<u>STEAM</u>	Not necessary		
<u>AIR</u>	Not necessary		
			R-600a
	Refrigeration power		0,357
	Consumption - kW-h	365 d.	913
		24 h	2,50
	Net volume - litres	Refrig.	922
	Internal gross capacity	litres	1.332
	Climat class	4	Energy Effic. C
<u>SOUND LEVEL</u>	< 65,00 db		
<u>CERTIFICATES</u>	SGS-2103-0906-1		
<u>INSTALLATION - CONNECTIONS</u>	Ø		
	► ELECTRICITY		SI

DESCRIPTION

REFRIGERATED CABINET GASTRONORM, EAFP-1603

SPECIFICATIONS

High quality austenitic stainless steel inside and outside (except for galvanized back panel).
 60 mm, 40 kg/m3 injected polyurethane isolation.
 Embedded inner tray slides. Storage trays at 23 different levels 55 mm from each other.
 Forced draught cooling system with hermetically sealed compressor. Copper piping and aluminium flaps evaporator.
 Digital display for electronic and digital control of temperature and defrosting.
 Opened door delay alarm.
 Self-closing and stay open doors. When opened less than 90° they close by themselves. When opened more than 135° they stay open.
 Built in drainage to get rid of waste liquids inside the unit.
 Embedded bottom and curved panels inside for easy cleaning and maintenance.
 Removable plastic covered steel grid shelves for easy cleaning.
 Equipment: 3 shelves per large door.
 Height adjustable stainless steel legs.
 Working temperature: from -2 °C up to +8 °C.
 Climatic class 4.
 Inner LED lights with power switch.

Doors: 3
 Energy efficiency: C
 Net capacity: 922 L
 Gross capacity: 1332 L
 Cooling power: 360 W
 Electric power: 180 W
 Annual energy consumption: 913 kWh/year
 Coolant: R-600a
 Dimensions: 1318x842x2040 mm





Catalogue :
CABINETS GLOBE

Chapter :
GLOBE CONCEPT GN CABINETS

Article :
EAFP-1603 230V 1N 50Hz

Code :
19037834

SCHEMA - DIMENSIONS

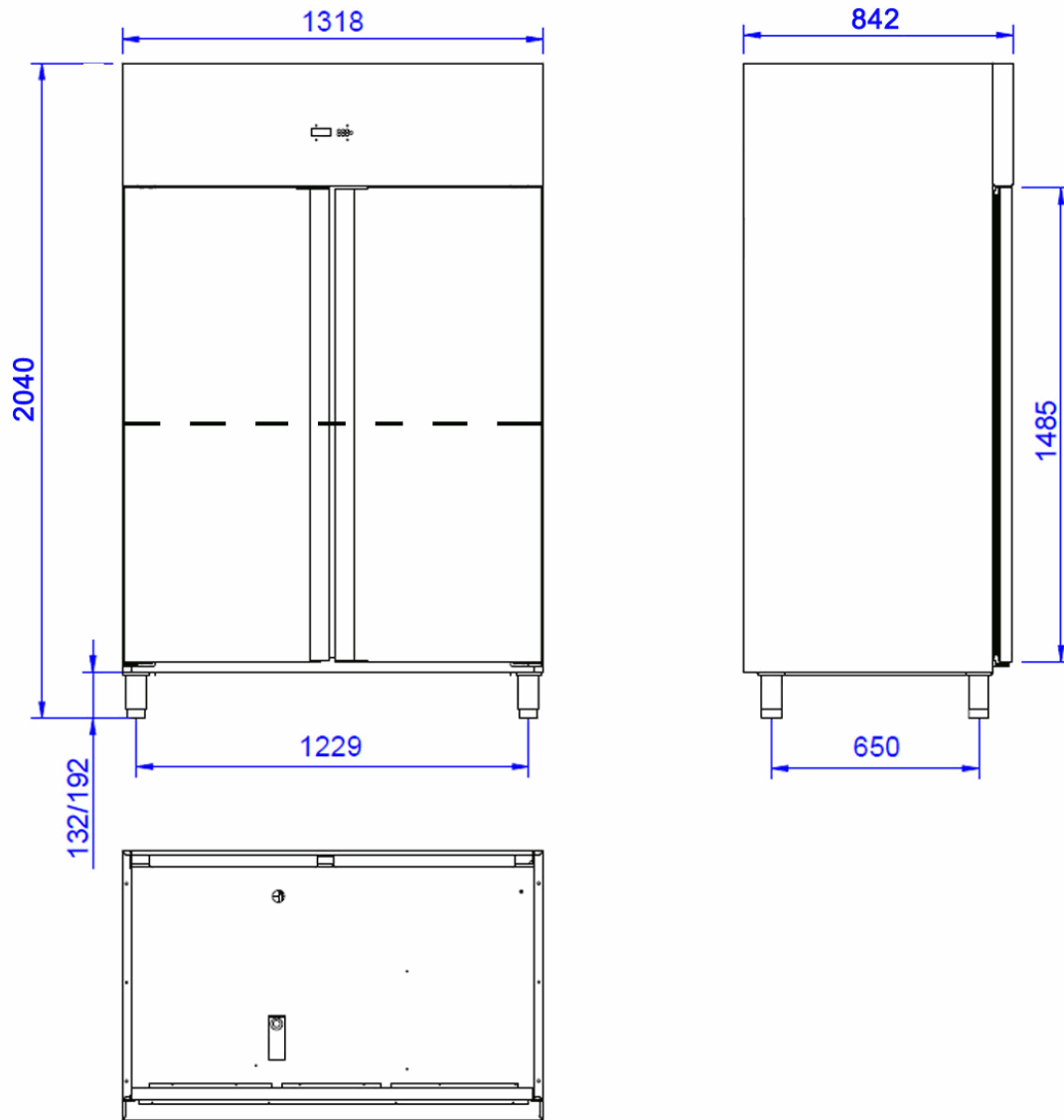



Catalogue :

CABINETS GLOBE

Chapter :

GLOBE CONCEPT GN CABINETS

Article :

EAFP-1604 230V 1N 50Hz

Code:

19037835

<u>DIMENSIONS AND WEIGHTS</u>		<u>Net dimensions</u>	<u>Packed</u>
Length	mm	1.318,00	860,00
Depth	mm	842,00	1.430,00
Height	mm	2.040,00	2.063,00
Weight	kg	225,00	230,00
Volume	m3	2,26	2,54

<u>ELECTRICITY</u>		<u>50Hz</u>	
Power	230V		0,21 kW
Connections	230 V. 1+N+T	2X1,5+T - 4 A	
	230 V. III+T	OPC3X4+T-32A	
	400 V. III+N+T	4X4MM2+T	

GAS Not necessary

WATER Not necessary

STEAM Not necessary

AIR Not necessary

DESCRIPTION

REFRIGERATED CABINET GASTRONORM, EAFP-1604

SPECIFICATIONS

High quality austenitic stainless steel inside and outside (except for galvanized back panel).
 60 mm, 40 kg/m3 injected polyurethane isolation.
 Embedded inner tray slides. Storage trays at 23 different levels 55 mm from each other.
 Forced draught cooling system with hermetically sealed compressor.
 Copper piping and aluminium flaps evaporator.
 Digital display for electronic and digital control of temperature and defrosting.
 Opened door delay alarm.
 Self-closing and stay open doors. When opened less than 90° they close by themselves. When opened more than 135° they stay open.
 Built in drainage to get rid of waste liquids inside the unit.
 Embedded bottom and curved panels inside for easy cleaning and maintenance.
 Removable plastic covered steel grid shelves for easy cleaning.
 Equipment: 3 shelves per large door.
 Height adjustable stainless steel legs.
 Working temperature: from -2 °C up to +8 °C.
 Climatic class 4.
 Inner LED lights with power switch.

Doors: 4
 Energy efficiency: C
 Net capacity: 922 L
 Gross capacity: 1332 L
 Cooling power: 360 W
 Electric power: 180 W
 Annual energy consumption: 913 kWh/year
 Coolant: R-600a
 Dimensions: 1318x842x2040 mm

		<u>R-600a</u>
Refrigeration power		0,357
Consumption - kW-h	365 d.	913
	24 h	2,50
Net volume - litres	Refrig.	922
Internal gross capacity	litres	1.332
Climat class	4	Energy Effic. C

SOUND LEVEL < **65,00** db

CERTIFICATES **SGS-2103-0906-1**

INSTALLATION - CONNECTIONS Ø
 ► ELECTRICITY SI





Catalogue :
CABINETS GLOBE

Chapter :
GLOBE CONCEPT GN CABINETS

Article :
EAFP-1604 230V 1N 50Hz

Code :
19037835

SCHEMA - DIMENSIONS

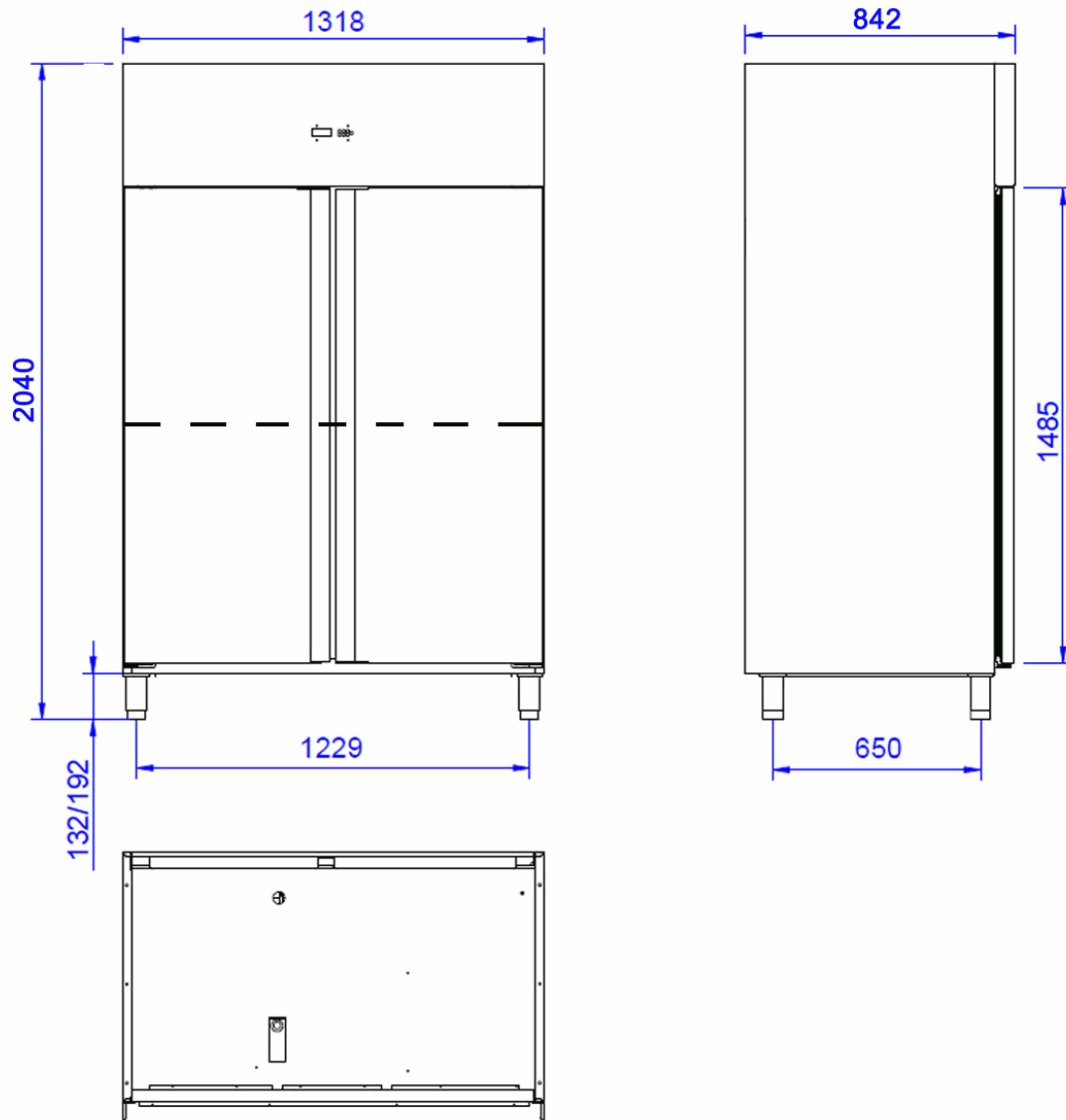



Catalogue :

CABINETS GLOBE

Chapter :

GLOBE CONCEPT GN CABINETS

Article :

EAEP-1602 230V 1N 50Hz

Code:

19037843

<u>DIMENSIONS AND WEIGHTS</u>		<u>Net dimensions</u>	<u>Packed</u>
Length	mm	1.318,00	860,00
Depth	mm	842,00	1.430,00
Height	mm	2.040,00	2.063,00
Weight	kg	210,00	220,00
Volume	m3	2,26	2,54
<u>ELECTRICITY</u>		230V	50Hz
Power			0,21 kW
Connections	230 V. 1+N+T	2X1,5+T - 4 A	
	230 V. III+T		
	400 V. III+N+T	2X(4X6MM2+T)	
<u>GAS</u>	Not necessary		
<u>WATER</u>	Not necessary		
<u>STEAM</u>	Not necessary		
<u>AIR</u>	Not necessary		
			R-600a
	Refrigeration power		0,357
	Internal gross capacity litres		1.332
	Climat class	4	
<u>SOUND LEVEL</u>			< 65,00 db
<u>CERTIFICATES</u>	SGS-2103-0906-1		
<u>INSTALLATION - CONNECTIONS</u>			Ø
	▶ ELECTRICITY	SI	

DESCRIPTION

REFRIGERATED DISPLAY CABINET GASTRONORM, EAEP-1602

SPECIFICATIONS

High quality austenitic stainless steel inside and outside (except for galvanized back panel).
 60 mm, 40 kg/m3 injected polyurethane isolation.
 Embedded inner tray slides. Storage trays at 23 different levels 55 mm from each other.
 Forced draught cooling system with hermetically sealed compressor.
 Copper piping and aluminium flaps evaporator.
 Digital display for electronic and digital control of temperature and defrosting.
 Opened door delay alarm.
 Self-closing and stay open doors. When opened less than 90° they close by themselves. When opened more than 135° they stay open.
 Built in drainage to get rid of waste liquids inside the unit.
 Embedded bottom and curved panels inside for easy cleaning and maintenance.
 Removable plastic covered steel grid shelves for easy cleaning.
 Equipment: 3 shelves per large door.
 Height adjustable stainless steel legs.
 Working temperature: from -2 °C up to +8 °C.
 Climatic class 4.
 Double pane door and anodised aluminium frame with double vacuum chamber.
 Inner LED lights with power switch.

Doors: 2
 Gross capacity: 1332 L
 Cooling power: 360 W
 Electric power: 180 W
 Coolant: R-600a
 Dimensions: 1318x842x2040 mm





Catalogue :
CABINETS GLOBE

Chapter :
GLOBE CONCEPT GN CABINETS

Article :
EAEP-1602 230V 1N 50Hz

Code :
19037843

SCHEMA - DIMENSIONS

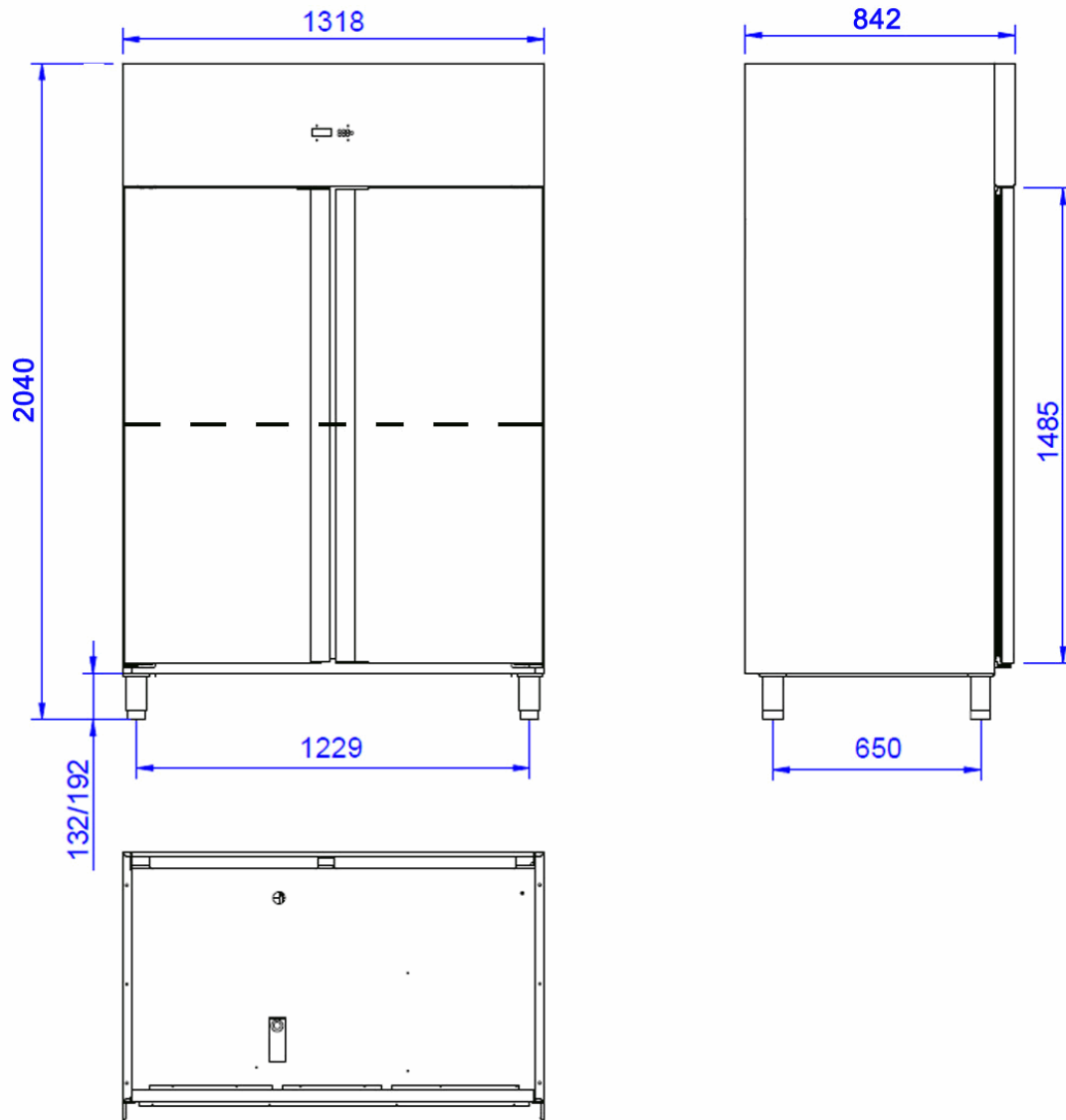



Catalogue :

CABINETS GLOBE

Chapter :

GLOBE CONCEPT GN CABINETS

Article :

EAFN-801 230V 1N 50Hz

Code:

19037864

<u>DIMENSIONS AND WEIGHTS</u>		<u>Net dimensions</u>	<u>Packed</u>
Length	mm	653,00	860,00
Depth	mm	842,00	730,00
Height	mm	2.040,00	2.063,00
Weight	kg	153,00	160,00
Volume	m3	1,09	1,30

<u>ELECTRICITY</u>		<u>50Hz</u>	
Power	230V		0,70 kW
Connections	230 V. 1+N+T	2X1,5+T - 4 A	
	230 V. III+T	OPC3X4+T-32A	
	400 V. III+N+T	4X4MM2+T	

GAS Not necessary

WATER Not necessary

STEAM Not necessary

AIR Not necessary

			R-290
Refrigeration power			0,364
Consumption - kW-h	365 d.		2.179
	24 h		5,97
Net volume - litres			
		Congel.	461
Internal gross capacity	litres		610
Climat class	4	Energy Effic.	D

SOUND LEVEL < **65,00** db

CERTIFICATES **SGS-2103-0906-1**

INSTALLATION - CONNECTIONS Ø
 ► ELECTRICITY SI

DESCRIPTION

FREEZER CABINET GASTRONORM, EAFN-801

SPECIFICATIONS

High quality austenitic stainless steel inside and outside (except for galvanized back panel).
 60 mm, 40 kg/m3 injected polyurethane isolation.
 Embedded inner tray slides. Storage trays at 23 different levels 55 mm from each other.
 Forced draught cooling system with hermetically sealed compressor.
 Copper piping and aluminium flaps evaporator.
 Digital display for electronic and digital control of temperature and defrosting.
 Opened door delay alarm.
 Self-closing and stay open doors. When opened less than 90° they close by themselves. When opened more than 135° they stay open.
 Built in drainage to get rid of waste liquids inside the unit.
 Embedded bottom and curved panels inside for easy cleaning and maintenance.
 Removable plastic covered steel grid shelves for easy cleaning.
 Equipment: 3 shelves per large door.
 Height adjustable stainless steel legs.
 Working temperature: from -18 °C up to -22 °C.
 Climatic class 4.
 Inner LED lights with power switch.

Doors: 1
 Energy efficiency: D
 Net capacity: 461 L
 Gross capacity: 610 L
 Cooling power: 280 W
 Electric power: 350 W
 Annual energy consumption: 2179 kWh/year
 Coolant: R-290
 Dimensions: 653x842x2040 mm





Catalogue :
CABINETS GLOBE

Chapter :
GLOBE CONCEPT GN CABINETS

Article :
EAFN-801 230V 1N 50Hz

Code :
19037864

SCHEMA - DIMENSIONS

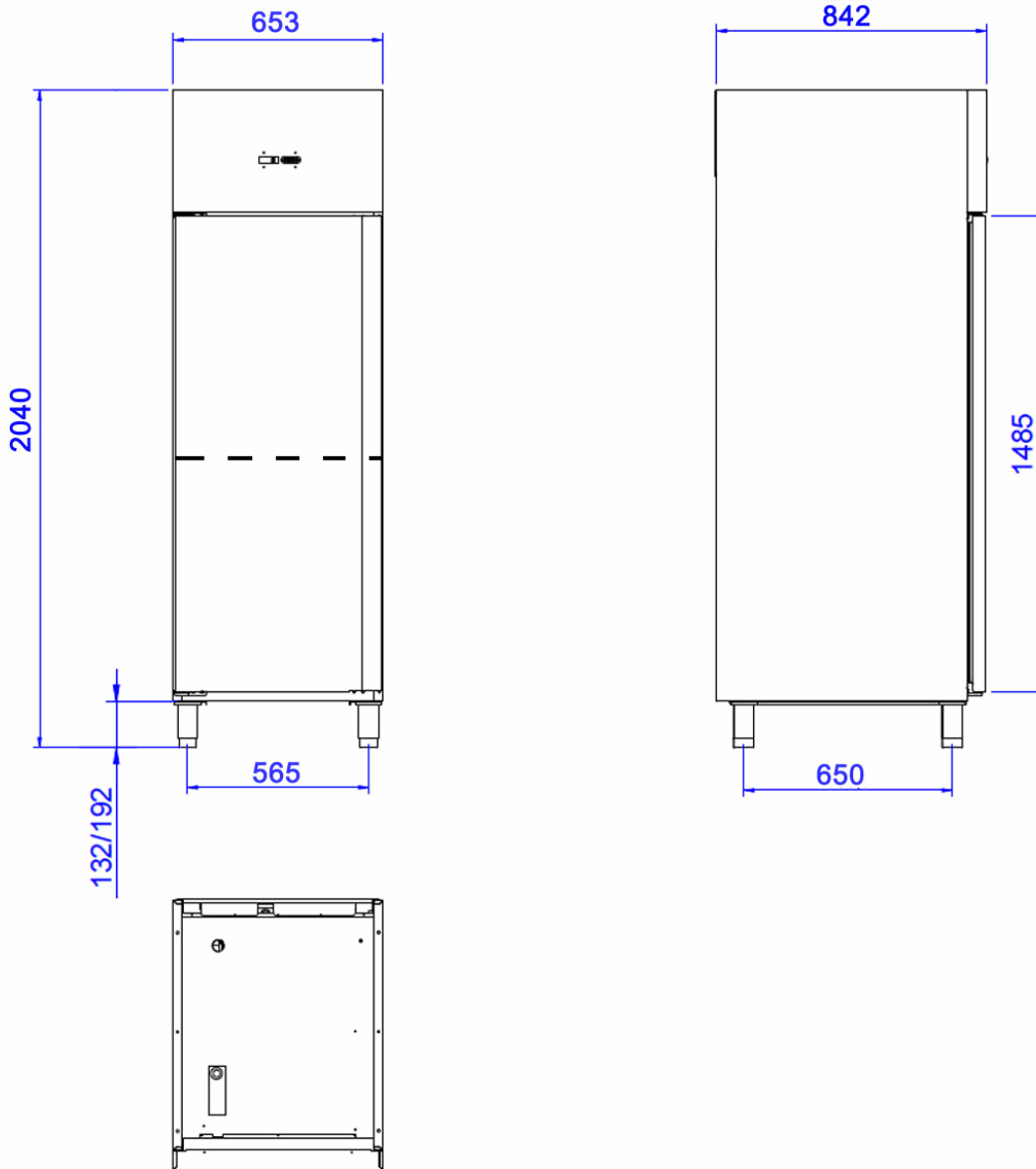



Catalogue :

CABINETS GLOBE

Chapter :

GLOBE CONCEPT GN CABINETS

Article :

EAFN-802 230V 1N 50Hz

Code:

19037868

<u>DIMENSIONS AND WEIGHTS</u>		<u>Net dimensions</u>	<u>Packed</u>
Length	mm	653,00	860,00
Depth	mm	842,00	730,00
Height	mm	2.040,00	2.063,00
Weight	kg	153,00	160,00
Volume	m3	1,12	1,30

<u>ELECTRICITY</u>		<u>50Hz</u>	
Power	230V		0,71 kW
Connections	230 V. 1+N+T	2X1,5+T - 4 A	
	230 V. III+T	OPC3X4+T-32A	
	400 V. III+N+T	4X4MM2+T	

GAS Not necessary

WATER Not necessary

STEAM Not necessary

AIR Not necessary

			R-290
Refrigeration power			0,364
Consumption - kW-h	365 d.		2.179
	24 h		5,97
Net volume - litres			
		Congel.	461
Internal gross capacity	litres		610
Climat class	4	Energy Effic.	D

SOUND LEVEL < **65,00** db

CERTIFICATES **SGS-2103-0906-1**

INSTALLATION - CONNECTIONS Ø

► ELECTRICITY SI

DESCRIPTION

FREEZER CABINET GASTRONORM, EAFN-802

SPECIFICATIONS

High quality austenitic stainless steel inside and outside (except for galvanized back panel).
60 mm, 40 kg/m3 injected polyurethane isolation.
Embedded inner tray slides. Storage trays at 23 different levels 55 mm from each other.
Forced draught cooling system with hermetically sealed compressor.
Copper piping and aluminium flaps evaporator.
Digital display for electronic and digital control of temperature and defrosting.
Opened door delay alarm.
Self-closing and stay open doors. When opened less than 90° they close by themselves. When opened more than 135° they stay open.
Built in drainage to get rid of waste liquids inside the unit.
Embedded bottom and curved panels inside for easy cleaning and maintenance.
Removable plastic covered steel grid shelves for easy cleaning.
Equipment: 3 shelves per large door.
Height adjustable stainless steel legs.
Working temperature: from -18 °C up to -22 °C.
Climatic class 4.
Inner LED lights with power switch.

Doors: 2
Energy efficiency: D
Net capacity: 461 L
Gross capacity: 610 L
Cooling power: 280 W
Electric power: 350 W
Annual energy consumption: 2179 kWh/year
Coolant: R-290
Dimensions: 653x842x2040 mm





Catalogue :
CABINETS GLOBE

Chapter :
GLOBE CONCEPT GN CABINETS

Article :
EAFN-802 230V 1N 50Hz

Code :
19037868

SCHEMA - DIMENSIONS

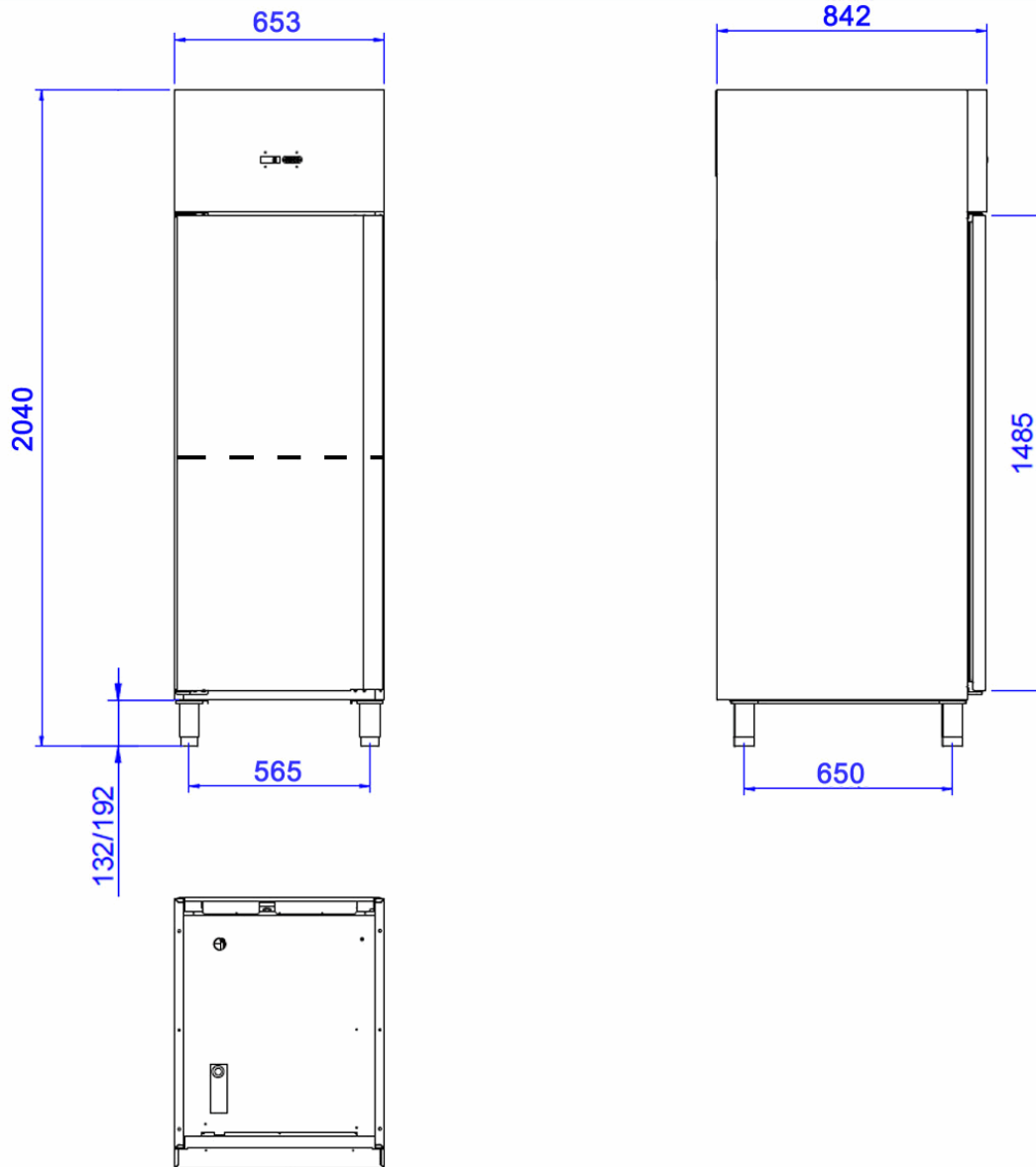



Catalogue :

CABINETS GLOBE

Chapter :

GLOBE CONCEPT GN CABINETS

Article :

EAFN-1602 230V 1N 50Hz

Code:

19037918

<u>DIMENSIONS AND WEIGHTS</u>		<u>Net dimensions</u>	<u>Packed</u>
Length	mm	1.318,00	860,00
Depth	mm	842,00	1.430,00
Height	mm	2.040,00	2.063,00
Weight	kg	225,00	230,00
Volume	m3	2,26	2,54

<u>ELECTRICITY</u>		<u>50Hz</u>	
Power			1,25 kW
Connections	230 V. 1+N+T	2X1,5+T - 4 A	
	230 V. III+T		
	400 V. III+N+T	2X(4X6MM2+T)	

GAS Not necessary

WATER Not necessary

STEAM Not necessary

AIR Not necessary

DESCRIPTION

FREEZER CABINET GASTRONORM, EAFN-1602

SPECIFICATIONS

High quality austenitic stainless steel inside and outside (except for galvanized back panel).
 60 mm, 40 kg/m3 injected polyurethane isolation.
 Embedded inner tray slides. Storage trays at 23 different levels 55 mm from each other.
 Forced draught cooling system with hermetically sealed compressor.
 Copper piping and aluminium flaps evaporator.
 Digital display for electronic and digital control of temperature and defrosting.
 Opened door delay alarm.
 Self-closing and stay open doors. When opened less than 90° they close by themselves. When opened more than 135° they stay open.
 Built in drainage to get rid of waste liquids inside the unit.
 Embedded bottom and curved panels inside for easy cleaning and maintenance.
 Removable plastic covered steel grid shelves for easy cleaning.
 Equipment: 3 shelves per large door.
 Height adjustable stainless steel legs.
 Working temperature: from -18 °C up to -22 °C.
 Climatic class 4.
 Inner LED lights with power switch.

Doors: 2
 Energy efficiency: E
 Net capacity: 922 L
 Gross capacity: 1332 L
 Cooling power: 730 W
 Electric power: 640 W
 Annual energy consumption: 4161 kWh/year
 Coolant: R-290
 Dimensions: 1318x842x2040 mm

			R-290
Refrigeration power			0,735
Consumption - kW-h	365 d.		4.161
	24 h		11,40
Net volume - litres			
	Congel.		922
Internal gross capacity	litres		1.332
Climat class	4	Energy Effic.	E

SOUND LEVEL < **65,00** db

CERTIFICATES **SGS-2103-0906-1**

INSTALLATION - CONNECTIONS Ø
 ► ELECTRICITY SI





Catalogue :
CABINETS GLOBE

Chapter :
GLOBE CONCEPT GN CABINETS

Article :
EAFN-1602 230V 1N 50Hz

Code :
19037918

SCHEMA - DIMENSIONS

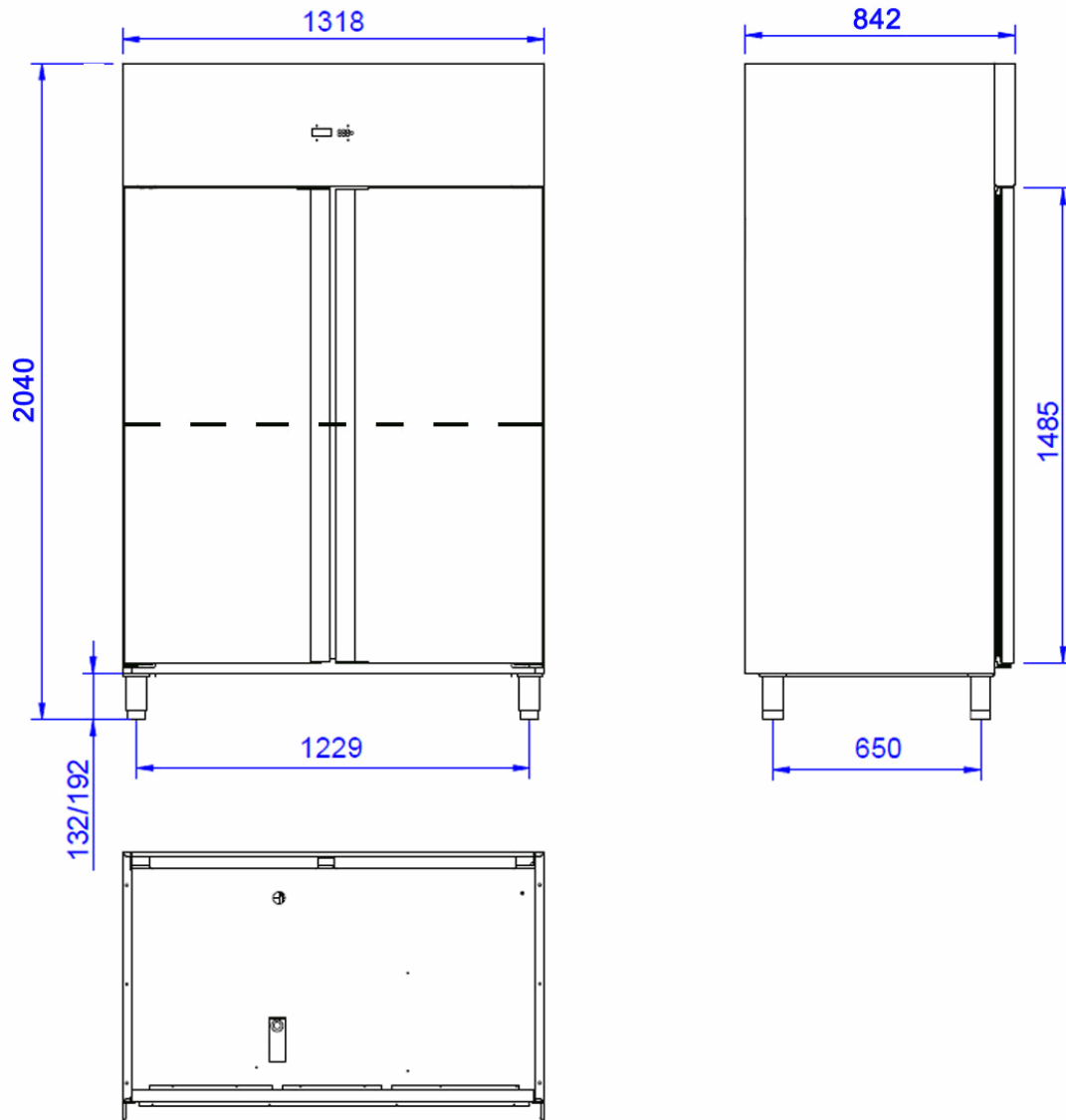



Catalogue :

CABINETS GLOBE

Chapter :

GLOBE CONCEPT GN CABINETS

Article :

EAFN-1603 230V 1N 50Hz

Code:

19037924

<u>DIMENSIONS AND WEIGHTS</u>		<u>Net dimensions</u>	<u>Packed</u>
Length	mm	1.318,00	860,00
Depth	mm	842,00	1.430,00
Height	mm	2.040,00	2.063,00
Weight	kg	225,00	230,00
Volume	m3	2,26	2,54

<u>ELECTRICITY</u>		<u>230V</u>	<u>50Hz</u>
Power			1,26 kW
Connections	230 V. 1+N+T	2X1,5+T - 4 A	
	230 V. III+T	OPC3X4+T-32A	
	400 V. III+N+T	4X4MM2+T	

GAS Not necessary

WATER Not necessary

STEAM Not necessary

AIR Not necessary

DESCRIPTION

FREEZER CABINET GASTRONORM, EAFN-1603

SPECIFICATIONS

High quality austenitic stainless steel inside and outside (except for galvanized back panel).
 60 mm, 40 kg/m3 injected polyurethane isolation.
 Embedded inner tray slides. Storage trays at 23 different levels 55 mm from each other.
 Forced draught cooling system with hermetically sealed compressor.
 Copper piping and aluminium flaps evaporator.
 Digital display for electronic and digital control of temperature and defrosting.
 Opened door delay alarm.
 Self-closing and stay open doors. When opened less than 90° they close by themselves. When opened more than 135° they stay open.
 Built in drainage to get rid of waste liquids inside the unit.
 Embedded bottom and curved panels inside for easy cleaning and maintenance.
 Removable plastic covered steel grid shelves for easy cleaning.
 Equipment: 3 shelves per large door.
 Height adjustable stainless steel legs.
 Working temperature: from -18 °C up to -22 °C.
 Climatic class 4.
 Inner LED lights with power switch.

Doors: 3
 Energy efficiency: E
 Net capacity: 922 L
 Gross capacity: 1332 L
 Cooling power: 730 W
 Electric power: 640 W
 Annual energy consumption: 4161 kWh/year
 Coolant: R-290
 Dimensions: 1318x842x2040 mm

			R-290
Refrigeration power			0,735
Consumption - kW-h	365 d.		4.161
	24 h		11,40
Net volume - litres			
		Congel.	922
Internal gross capacity	litres		1.332
Climat class	4	Energy Effic.	E

SOUND LEVEL < **65,00** db

CERTIFICATES **SGS-2103-0906-1**

INSTALLATION - CONNECTIONS Ø
 ► ELECTRICITY SI





Catalogue :
CABINETS GLOBE

Chapter :
GLOBE CONCEPT GN CABINETS

Article :
EAFN-1603 230V 1N 50Hz

Code :
19037924

SCHEMA - DIMENSIONS

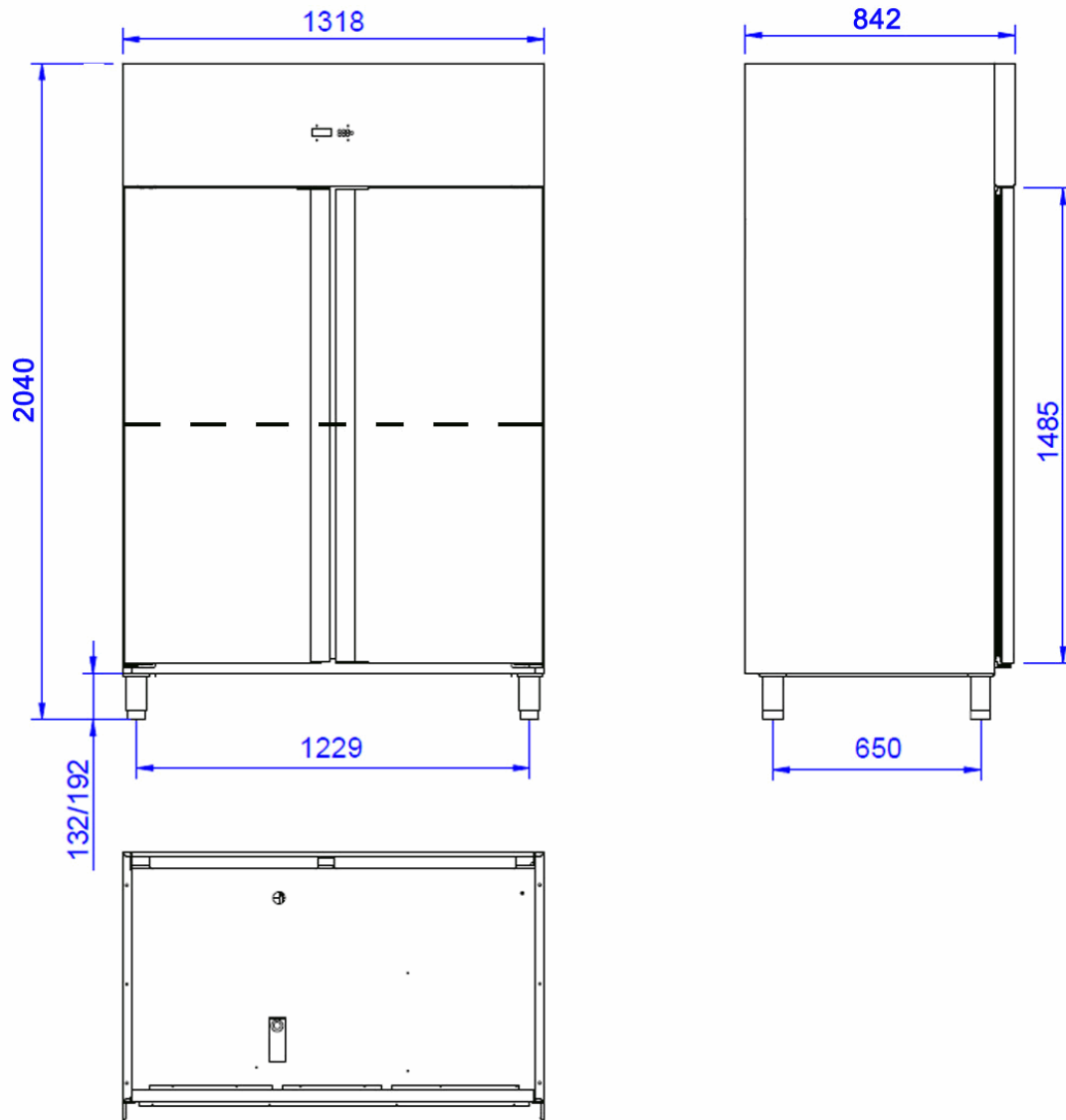



Catalogue :

CABINETS GLOBE

Chapter :

GLOBE CONCEPT GN CABINETS

Article :

EAFN-1604 230V 1N 50Hz

Code:

19037925

<u>DIMENSIONS AND WEIGHTS</u>		<u>Net dimensions</u>	<u>Packed</u>
Length	mm	1.318,00	860,00
Depth	mm	842,00	1.430,00
Height	mm	2.040,00	2.063,00
Weight	kg	225,00	230,00
Volume	m3	2,26	2,54

<u>ELECTRICITY</u>		<u>230V</u>	<u>50Hz</u>
Power			1,26 kW
Connections	230 V. 1+N+T	2X1,5+T - 4 A	
	230 V. III+T	OPC3X4+T-32A	
	400 V. III+N+T	4X4MM2+T	

GAS Not necessary

WATER Not necessary

STEAM Not necessary

AIR Not necessary

DESCRIPTION

FREEZER CABINET GASTRONORM, EAFN-1604

SPECIFICATIONS

High quality austenitic stainless steel inside and outside (except for galvanized back panel).
 60 mm, 40 kg/m3 injected polyurethane isolation.
 Embedded inner tray slides. Storage trays at 23 different levels 55 mm from each other.
 Forced draught cooling system with hermetically sealed compressor.
 Copper piping and aluminium flaps evaporator.
 Digital display for electronic and digital control of temperature and defrosting.
 Opened door delay alarm.
 Self-closing and stay open doors. When opened less than 90° they close by themselves. When opened more than 135° they stay open.
 Built in drainage to get rid of waste liquids inside the unit.
 Embedded bottom and curved panels inside for easy cleaning and maintenance.
 Removable plastic covered steel grid shelves for easy cleaning.
 Equipment: 3 shelves per large door.
 Height adjustable stainless steel legs.
 Working temperature: from -18 °C up to -22 °C.
 Climatic class 4.
 Inner LED lights with power switch.

Doors: 4
 Energy efficiency: E
 Net capacity: 922 L
 Gross capacity: 1332 L
 Cooling power: 730 W
 Electric power: 640 W
 Annual energy consumption: 4161 kWh/year
 Coolant: R-290
 Dimensions: 1318x842x2040 mm

			R-290
Refrigeration power			0,735
Consumption - kW-h	365 d.		4.161
	24 h		11,40
Net volume - litres			
		Congel.	922
Internal gross capacity	litres		1.332
Climat class	4	Energy Effic.	E

SOUND LEVEL < **65,00** db

CERTIFICATES **SGS-2103-0906-1**

INSTALLATION - CONNECTIONS Ø
 ► ELECTRICITY SI





Catalogue :
CABINETS GLOBE

Chapter :
GLOBE CONCEPT GN CABINETS

Article :
EAFN-1604 230V 1N 50Hz

Code :
19037925

SCHEMA - DIMENSIONS

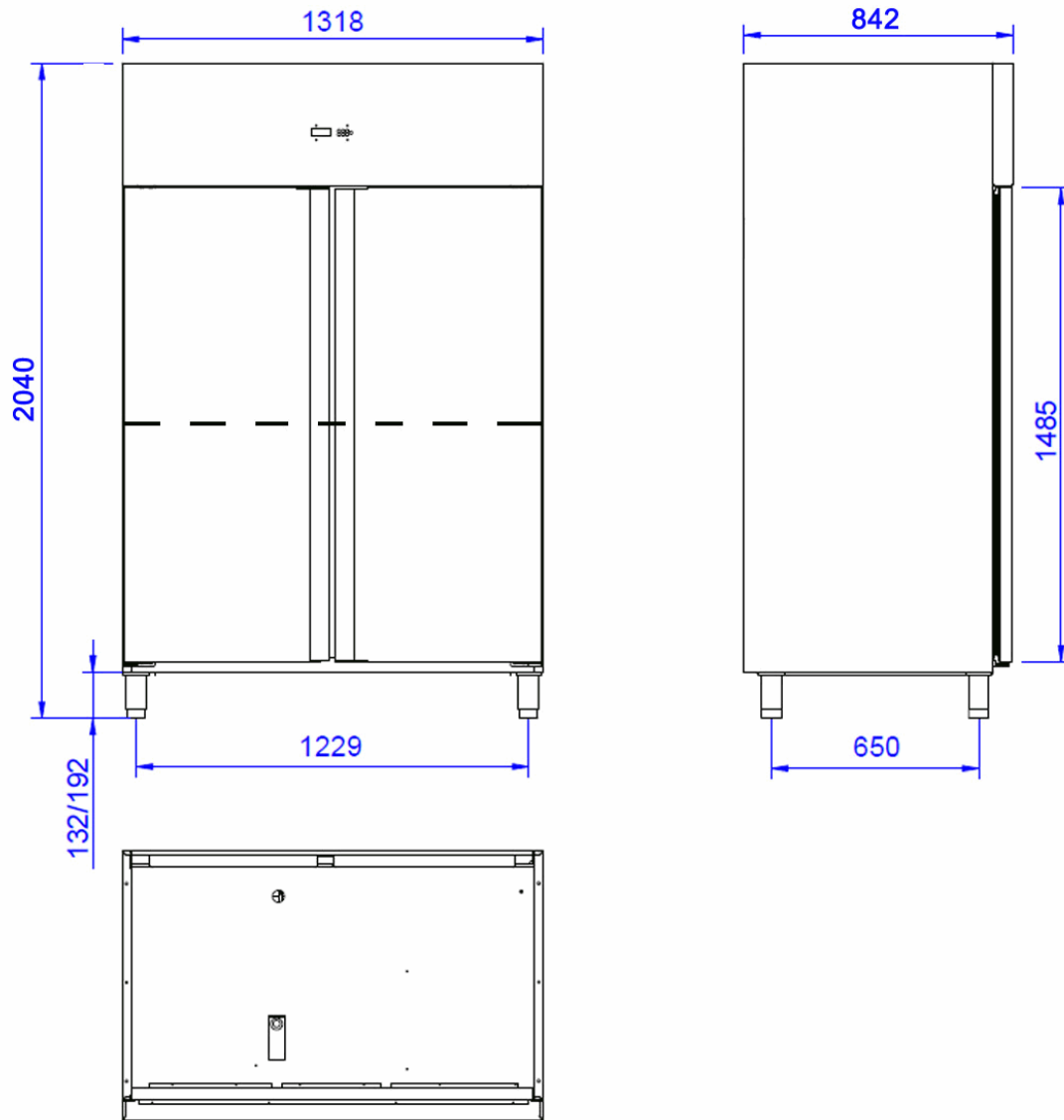



Catalogue :

CABINETS GLOBE

Chapter :

GLOBE CONCEPT GN CABINETS

Article :

EAF-1602 MIX 230V 1N 50Hz

Code:

19038287

<u>DIMENSIONS AND WEIGHTS</u>		<u>Net dimensions</u>	<u>Packed</u>
Length	mm	1.318,00	860,00
Depth	mm	842,00	1.430,00
Height	mm	2.040,00	2.063,00
Weight	kg	271,00	276,00
Volume	m3	2,26	2,54
<u>ELECTRICITY</u>		230V	50Hz
	Power		0,16 kW
Connections	230 V. 1+N+T	2X2,5+T - 8 A	
	230 V. III+T		
	400 V. III+N+T	2X(4X6MM2+T)	
<u>GAS</u>	Not necessary		
<u>WATER</u>	Not necessary		
<u>STEAM</u>	Not necessary		
<u>AIR</u>	Not necessary		
	Refrigeration power		0,310
	Internal gross capacity litres		1.332
	Climat class	4	
<u>SOUND LEVEL</u>			< 65,00 db
<u>CERTIFICATES</u>	SGS-2103-0906-1		
<u>INSTALLATION - CONNECTIONS</u>			Ø
	► ELECTRICITY	SI	

DESCRIPTION

MIXED CABINET GASTRONORM, EAF-1602 MIX

SPECIFICATIONS

High quality austenitic stainless steel inside and outside (except for galvanized back panel).
 60 mm, 40 kg/m3 injected polyurethane isolation.
 Embedded inner tray slides. Storage trays at 23 different levels 55 mm from each other.
 Forced draught cooling system with hermetically sealed compressor. Copper piping and aluminium flaps evaporator.
 Digital display for electronic and digital control of temperature and defrosting.
 Opened door delay alarm.
 Self-closing and stay open doors. When opened less than 90° they close by themselves. When opened more than 135° they stay open.
 Built in drainage to get rid of waste liquids inside the unit.
 Embedded bottom and curved panels inside for easy cleaning and maintenance.
 Removable plastic covered steel grid shelves for easy cleaning.
 Equipment: 3 shelves per large door.
 Height adjustable stainless steel legs.
 Models with two storage temperatures and independent refrigeration systems.
 Working temperature: from -2 °C to +8 °C (refrigerators) and from -18 °C to -22 °C (freezers).
 Climatic class 4.
 Inner LED lights with power switch.

Doors: 1+1
 Gross capacity: 1332 L
 Cooling power: 309+275 W
 Electric power: 158+352 W
 Coolant: R-600a+R-290
 Dimensions: 1318x842x2040 mm





Catalogue :
CABINETS GLOBE

Chapter :
GLOBE CONCEPT GN CABINETS

Article :
EAF-1602 MIX 230V 1N 50Hz

Code :
19038287

SCHEMA - DIMENSIONS

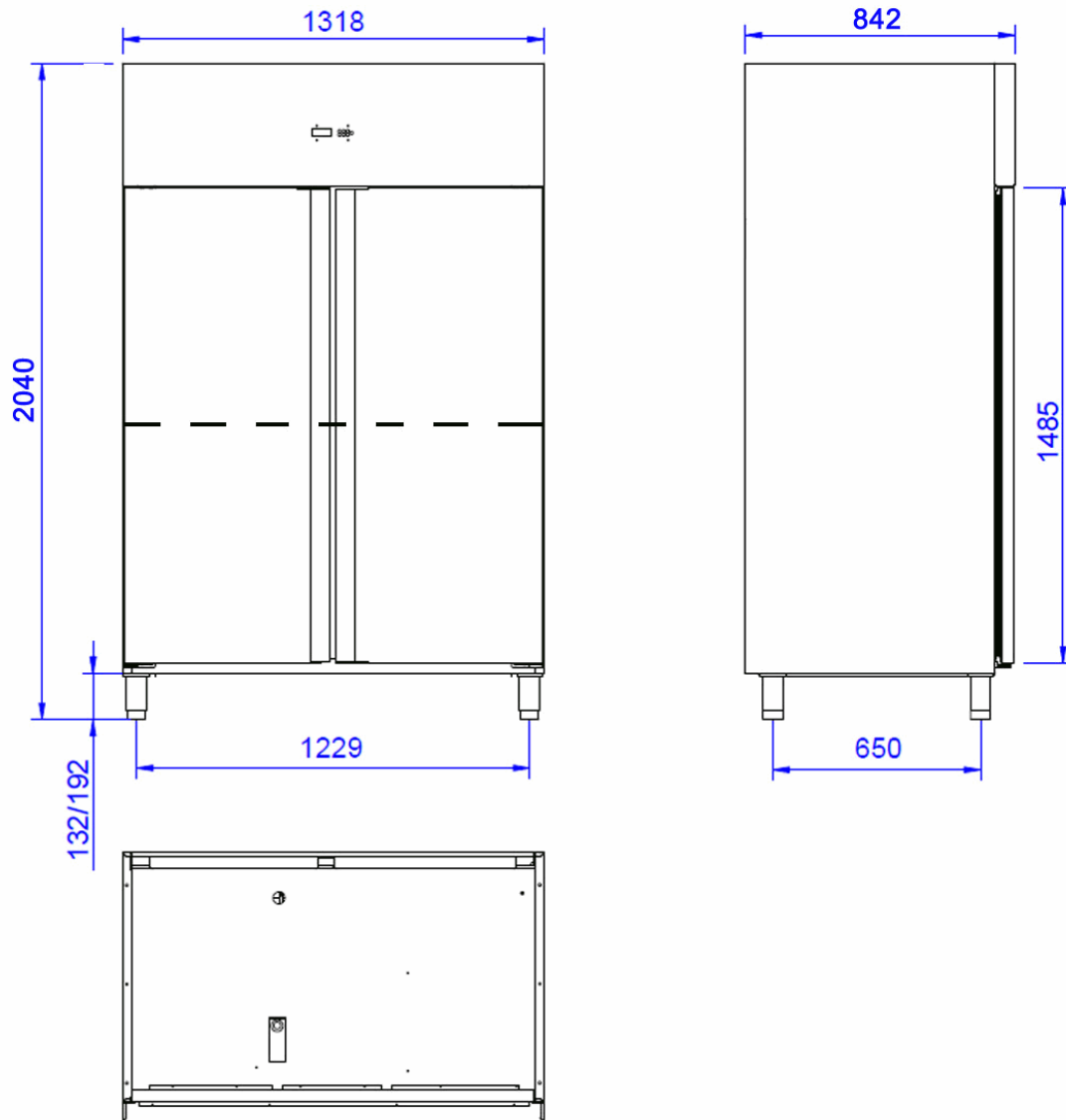



Catalogue :

CABINETS GLOBE

Chapter :

GLOBE CONCEPT GN CABINETS

Article :

EAF-802 C 230V 1N 50Hz

Code:

19038516

<u>DIMENSIONS AND WEIGHTS</u>		<u>Net dimensions</u>	<u>Packed</u>
Length	mm	693,00	860,00
Depth	mm	826,00	730,00
Height	mm	2.008,00	2.027,00
Weight	kg	184,00	189,00
Volume	m3	1,15	1,27
<u>ELECTRICITY</u>		230V	50Hz
	Power		0,24 kW
Connections	230 V. 1+N+T	2X1,5+T - 4 A	
	230 V. III+T		
	400 V. III+N+T	2X(4X6MM2+T)	
<u>GAS</u>	Not necessary		
<u>WATER</u>	Not necessary		
<u>STEAM</u>	Not necessary		
<u>AIR</u>	Not necessary		
			R-290
	Refrigeration power		0,352
	Internal gross capacity litres		596
	Climat class	4	
<u>SOUND LEVEL</u>			< 65,00 db
<u>CERTIFICATES</u>	SGS-2103-0906-1		
<u>INSTALLATION - CONNECTIONS</u>			Ø
	▶ ELECTRICITY		SI

DESCRIPTION

REFRIGERATION CABINET WITH FREEZING COMPARTMENT GASTRONORM, EAF-802 C

SPECIFICATIONS

High quality austenitic stainless steel inside and outside (except for galvanized back panel).
 60 mm, 40 kg/m3 injected polyurethane isolation.
 Embedded inner tray slides. Storage trays at 23 different levels 55 mm from each other.
 Forced draught cooling system with hermetically sealed compressor.
 Copper piping and aluminium flaps evaporator.
 Digital display for electronic and digital control of temperature and defrosting.
 Opened door delay alarm.
 Self-closing and stay open doors. When opened less than 90° they close by themselves. When opened more than 135° they stay open.
 Built in drainage to get rid of waste liquids inside the unit.
 Embedded bottom and curved panels inside for easy cleaning and maintenance.
 Removable plastic covered steel grid shelves for easy cleaning.
 Equipment: 3 shelves per large door.
 Height adjustable stainless steel legs.
 Models with two storage temperatures and independent refrigeration systems.
 Working temperature: from -2 °C to +8 °C (refrigerators) and from -18 °C to -22 °C (freezer compartment).
 Climatic class 4.
 Inner LED lights with power switch.

Doors: 1+1 freezing compartment
 Gross capacity: 596 L
 Cooling power: 176+176 W
 Electric power: 242+185 W
 Coolant: R-290
 Dimensions: 693x826x2008 mm





Catalogue :
CABINETS GLOBE

Chapter :
GLOBE CONCEPT GN CABINETS

Article :
EAF-802 C 230V 1N 50Hz

Code :
19038516

SCHEMA - DIMENSIONS

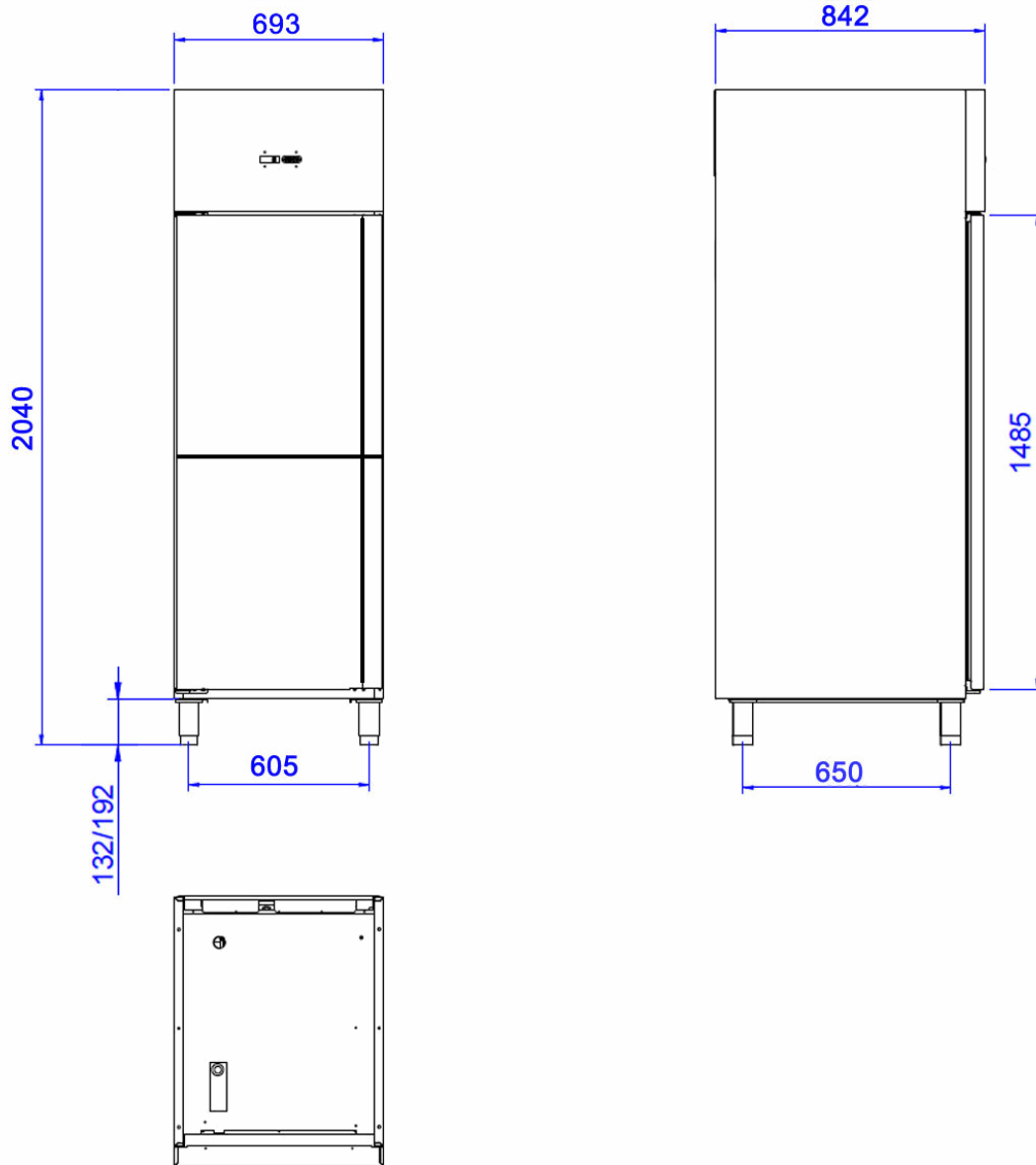



Catalogue :

CABINETS GLOBE

Chapter :

GLOBE CONCEPT GN CABINETS

Article :

EAF-802 P 230V 1N 50Hz

Code:

19038518

<u>DIMENSIONS AND WEIGHTS</u>		<u>Net dimensions</u>	<u>Packed</u>
Length	mm	693,00	860,00
Depth	mm	826,00	730,00
Height	mm	2.008,00	2.027,00
Weight	kg	184,00	189,00
Volume	m3	1,15	1,27

<u>ELECTRICITY</u>		<u>230V</u>	<u>50Hz</u>
Power			0,22 kW
Connections	230 V. 1+N+T	2X1,5+T - 4 A	
	230 V. III+T		
	400 V. III+N+T	2X(4X6MM2+T)	

GAS Not necessary

WATER Not necessary

STEAM Not necessary

AIR Not necessary

			R-290
Refrigeration power			0,352
Consumption - kW-h	365 d.		679
	24 h		1,86
Net volume - litres	Refrig.		218
Internal gross capacity	litres		596
Climat class	4	Energy Effic.	D

SOUND LEVEL < **65,00** db

CERTIFICATES **SGS-2103-0906-1**

INSTALLATION - CONNECTIONS Ø
 ► ELECTRICITY SI

DESCRIPTION

REFRIGERATION CABINET WITH FISH COMPARTMENT GASTRONORM, EAF-802 P

SPECIFICATIONS

High quality austenitic stainless steel inside and outside (except for galvanized back panel).
 60 mm, 40 kg/m3 injected polyurethane isolation.
 Embedded inner tray slides. Storage trays at 23 different levels 55 mm from each other.
 Forced draught cooling system with hermetically sealed compressor.
 Copper piping and aluminium flaps evaporator.
 Digital display for electronic and digital control of temperature and defrosting.
 Opened door delay alarm.
 Self-closing and stay open doors. When opened less than 90° they close by themselves. When opened more than 135° they stay open.
 Built in drainage to get rid of waste liquids inside the unit.
 Embedded bottom and curved panels inside for easy cleaning and maintenance.
 Removable plastic covered steel grid shelves for easy cleaning.
 Equipment: 3 shelves per large door.
 Height adjustable stainless steel legs.
 Models with two storage temperatures and independent refrigeration systems.
 Working temperature: from -2 °C to +8 °C (refrigerators) and from -4 °C to -1°C (fish compartment).
 A compartment fitted with three sanitary PVC drawers with perforated steel double bottom. The compartment includes an independent hermetically sealed ventilated compressor.
 Climatic class 4.
 Inner LED lights with power switch.

Doors: 1+1 fish compartment
 Energy efficiency: D
 Net capacity: 218 L
 Gross capacity: 596 L
 Cooling power: 176+176 W
 Electric power: 216+209 W
 Annual energy consumption: 679 kWh/year
 Coolant: R-290
 Dimensions: 693x826x2008 mm





Catalogue :
CABINETS GLOBE

Chapter :
GLOBE CONCEPT GN CABINETS

Article :
EAF-802 P 230V 1N 50Hz

Code :
19038518

SCHEMA - DIMENSIONS

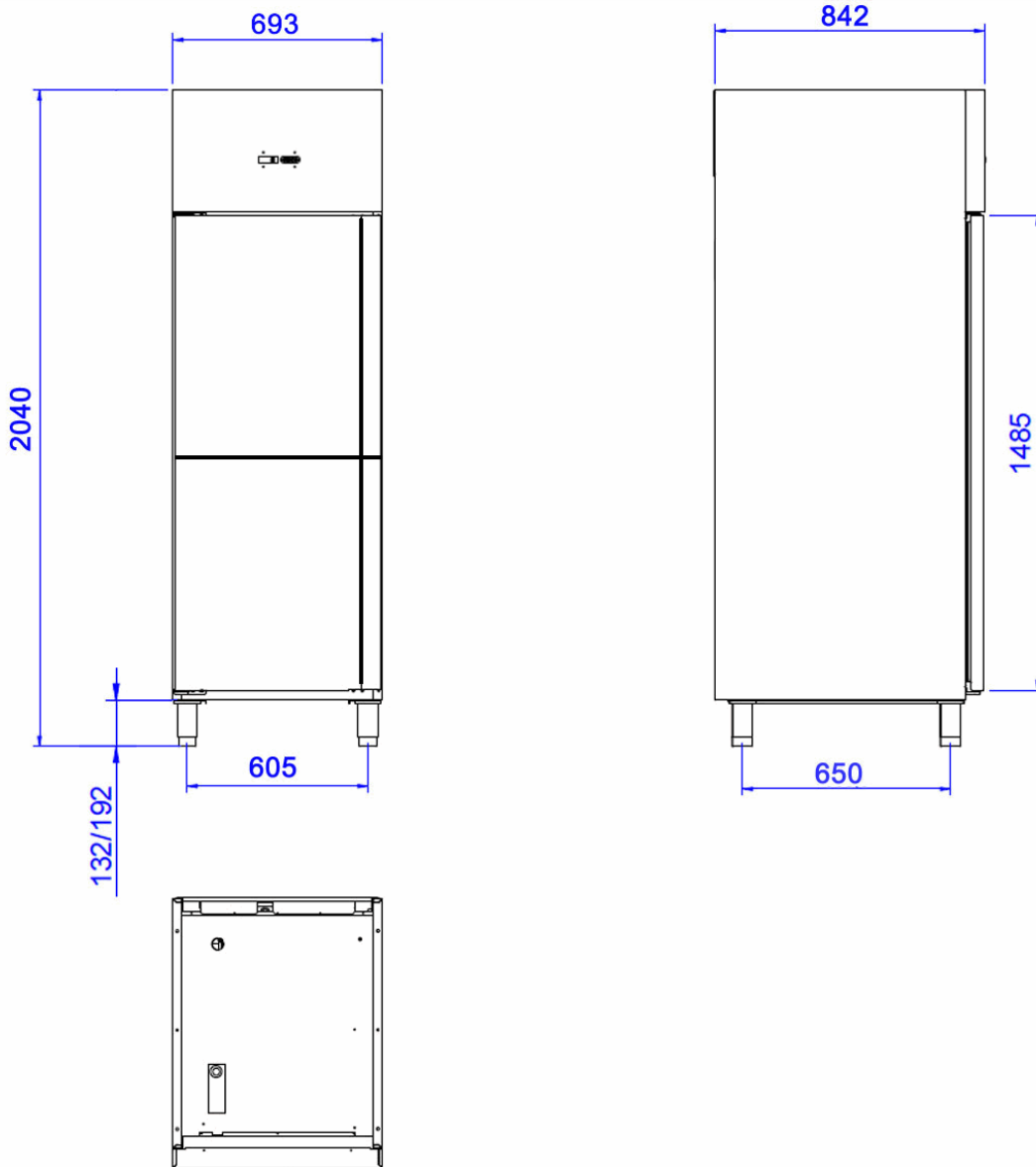



Catalogue :

CABINETS GLOBE

Chapter :

GLOBE CONCEPT GN CABINETS

Article :

EAF-1603 C 230V 1N 50Hz

Code:

19038521

<u>DIMENSIONS AND WEIGHTS</u>		<u>Net dimensions</u>	<u>Packed</u>
Length	mm	1.388,00	860,00
Depth	mm	826,00	1.430,00
Height	mm	2.008,00	2.027,00
Weight	kg	264,00	269,00
Volume	m3	2,30	2,49
<u>ELECTRICITY</u>		50Hz	
	230V		
	Power		0,23 kW
Connections	230 V. 1+N+T	2X1,5+T - 4 A	
	230 V. III+T		
	400 V. III+N+T	2X(4X6MM2+T)	
<u>GAS</u>	Not necessary		
<u>WATER</u>	Not necessary		
<u>STEAM</u>	Not necessary		
<u>AIR</u>	Not necessary		
	Refrigeration power		0,360
	Internal gross capacity litres		1.301
	Climat class	4	
<u>SOUND LEVEL</u>			< 65,00 db
<u>CERTIFICATES</u>	SGS-2103-0906-1		
<u>INSTALLATION - CONNECTIONS</u>			Ø
	▶ ELECTRICITY	SI	

DESCRIPTION

REFRIGERATION CABINET WITH FREEZING COMPARTMENT GASTRONORM, EAF-1603 C

SPECIFICATIONS

High quality austenitic stainless steel inside and outside (except for galvanized back panel).
 60 mm, 40 kg/m3 injected polyurethane isolation.
 Embedded inner tray slides. Storage trays at 23 different levels 55 mm from each other.
 Forced draught cooling system with hermetically sealed compressor.
 Copper piping and aluminium flaps evaporator.
 Digital display for electronic and digital control of temperature and defrosting.
 Opened door delay alarm.
 Self-closing and stay open doors. When opened less than 90° they close by themselves. When opened more than 135° they stay open.
 Built in drainage to get rid of waste liquids inside the unit.
 Embedded bottom and curved panels inside for easy cleaning and maintenance.
 Removable plastic covered steel grid shelves for easy cleaning.
 Equipment: 3 shelves per large door.
 Height adjustable stainless steel legs.
 Models with two storage temperatures and independent refrigeration systems.
 Working temperature: from -2 °C to +8 °C (refrigerators) and from -18 °C to -22 °C (freezer compartment).
 Climatic class 4.
 Inner LED lights with power switch.

Doors: 2+1 freezing compartment
 Gross capacity: 1301 L
 Cooling power: 357+176 W
 Electric power: 231+185 W
 Coolant: R-600a+R-290
 Dimensions: 1388x826x2008 mm





Catalogue :
CABINETS GLOBE

Chapter :
GLOBE CONCEPT GN CABINETS

Article :
EAF-1603 C 230V 1N 50Hz

Code :
19038521

SCHEMA - DIMENSIONS

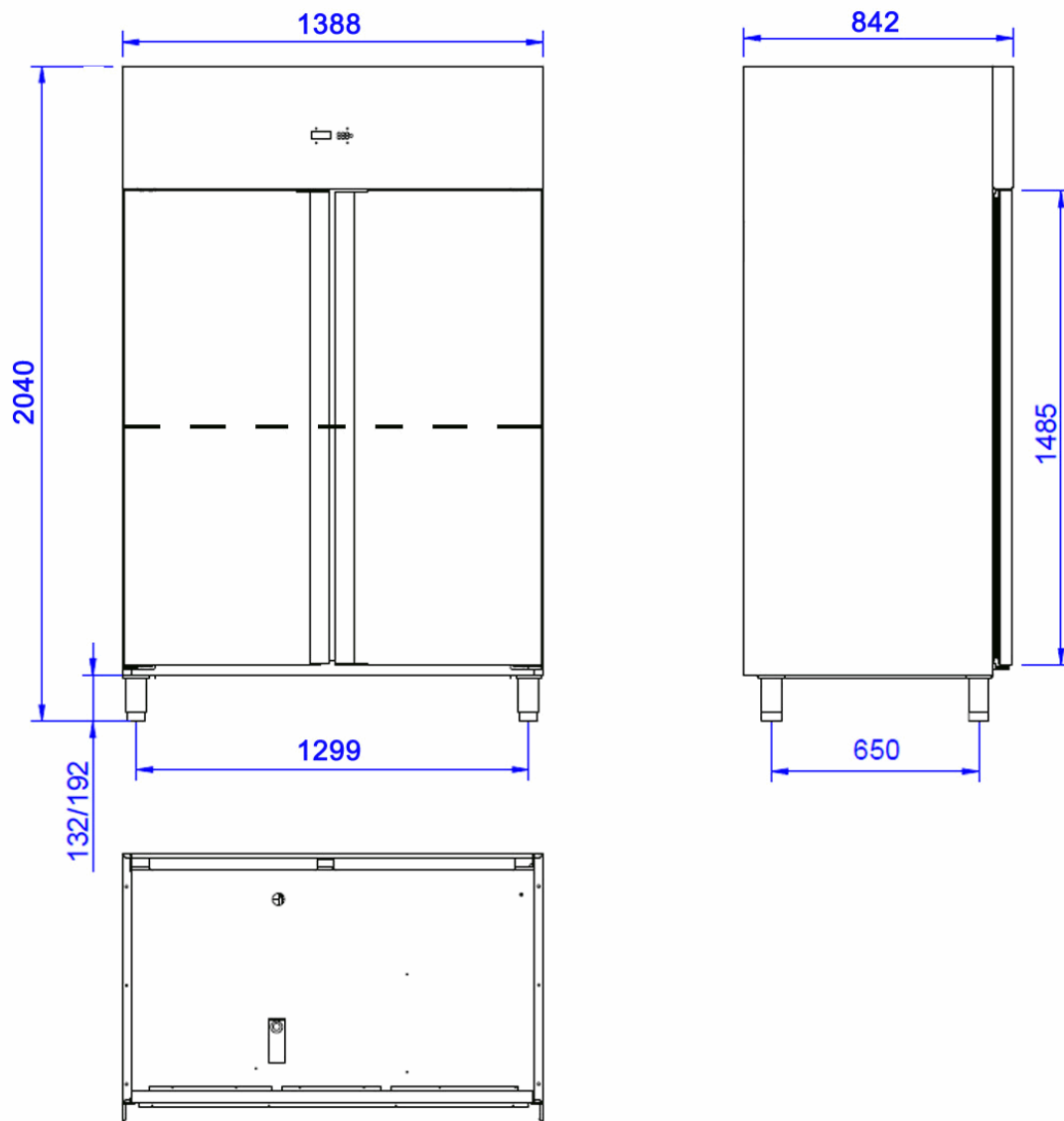



Catalogue :

CABINETS GLOBE

Chapter :

GLOBE CONCEPT GN CABINETS

Article :

EAF-1604 C 230V 1N 50Hz

Code:

19038522

<u>DIMENSIONS AND WEIGHTS</u>		<u>Net dimensions</u>	<u>Packed</u>
Length	mm	1.388,00	860,00
Depth	mm	826,00	1.430,00
Height	mm	2.008,00	2.027,00
Weight	kg	264,00	269,00
Volume	m3	2,30	2,49
<u>ELECTRICITY</u>		50Hz	
	230V		
	Power		0,23 kW
Connections	230 V. 1+N+T	2X1,5+T - 4 A	
	230 V. III+T		
	400 V. III+N+T	2X(4X6MM2+T)	
<u>GAS</u>	Not necessary		
<u>WATER</u>	Not necessary		
<u>STEAM</u>	Not necessary		
<u>AIR</u>	Not necessary		
	Refrigeration power		0,360
	Internal gross capacity litres		1.301
	Climat class	4	
<u>SOUND LEVEL</u>			< 65,00 db
<u>CERTIFICATES</u>	SGS-2103-0906-1		
<u>INSTALLATION - CONNECTIONS</u>			Ø
	▶ ELECTRICITY	SI	

DESCRIPTION

REFRIGERATION CABINET WITH FREEZING COMPARTMENT GASTRONORM, EAF-1604 C

SPECIFICATIONS

High quality austenitic stainless steel inside and outside (except for galvanized back panel).
 60 mm, 40 kg/m3 injected polyurethane isolation.
 Embedded inner tray slides. Storage trays at 23 different levels 55 mm from each other.
 Forced draught cooling system with hermetically sealed compressor.
 Copper piping and aluminium flaps evaporator.
 Digital display for electronic and digital control of temperature and defrosting.
 Opened door delay alarm.
 Self-closing and stay open doors. When opened less than 90° they close by themselves. When opened more than 135° they stay open.
 Built in drainage to get rid of waste liquids inside the unit.
 Embedded bottom and curved panels inside for easy cleaning and maintenance.
 Removable plastic covered steel grid shelves for easy cleaning.
 Equipment: 3 shelves per large door.
 Height adjustable stainless steel legs.
 Models with two storage temperatures and independent refrigeration systems.
 Working temperature: from -2 °C to +8 °C (refrigerators) and from -18 °C to -22 °C (freezer compartment).
 Climatic class 4.
 Inner LED lights with power switch.

Doors: 3+1 freezing compartment
 Gross capacity: 1301 L
 Cooling power: 357+176 W
 Electric power: 231+185 W
 Coolant: R-600a+R-290
 Dimensions: 1388x826x2008 mm





Catalogue :
CABINETS GLOBE

Chapter :
GLOBE CONCEPT GN CABINETS

Article :
EAF-1604 C 230V 1N 50Hz

Code :
19038522

SCHEMA - DIMENSIONS

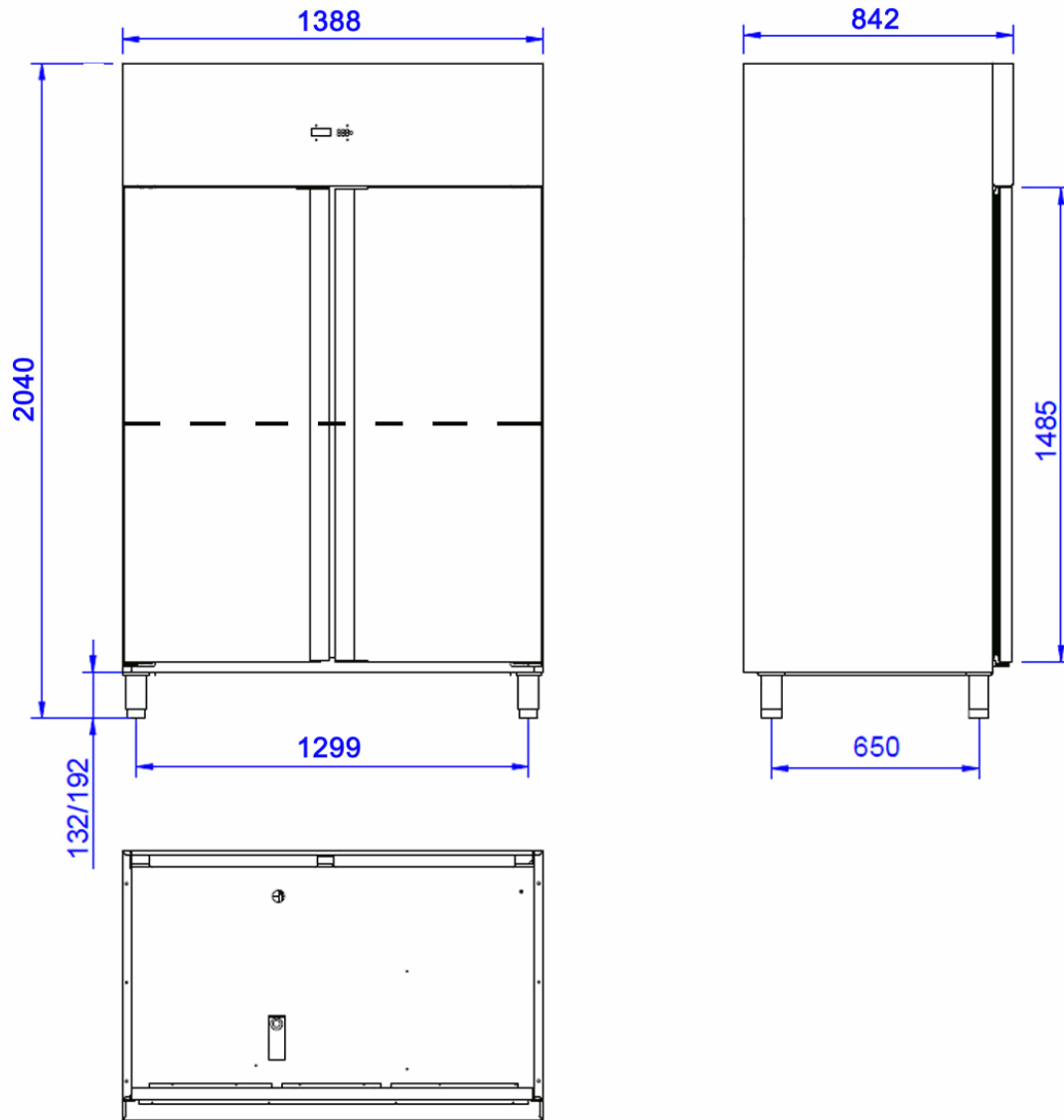



Catalogue :

CABINETS GLOBE

Chapter :

GLOBE CONCEPT GN CABINETS

Article :

EAF-1603 P 230V 1N 50Hz

Code:

19038531

<u>DIMENSIONS AND WEIGHTS</u>		<u>Net dimensions</u>	<u>Packed</u>
Length	mm	1.388,00	860,00
Depth	mm	826,00	1.430,00
Height	mm	2.008,00	2.027,00
Weight	kg	264,00	269,00
Volume	m3	2,30	2,49
<u>ELECTRICITY</u>		50Hz	
	Power		0,19 kW
Connections	230 V. 1+N+T	2X1,5+T - 4 A	
	230 V. III+T		
	400 V. III+N+T	2X(4X6MM2+T)	
<u>GAS</u>	Not necessary		
<u>WATER</u>	Not necessary		
<u>STEAM</u>	Not necessary		
<u>AIR</u>	Not necessary		
	Refrigeration power		0,360
	Consumption - kW-h	365 d.	906
		24 h	2,48
	Net volume - litres	Refrig.	656
	Internal gross capacity	litres	1.301
	Climat class	4	Energy Effic. D
<u>SOUND LEVEL</u>	< 65,00 db		
<u>CERTIFICATES</u>	SGS-2103-0906-1		
<u>INSTALLATION - CONNECTIONS</u>	Ø		
	► ELECTRICITY		SI

DESCRIPTION

REFRIGERATION CABINET WITH FISH COMPARTMENT GASTRONORM, EAF-1603 P

SPECIFICATIONS

High quality austenitic stainless steel inside and outside (except for galvanized back panel).
 60 mm, 40 kg/m3 injected polyurethane isolation.
 Embedded inner tray slides. Storage trays at 23 different levels 55 mm from each other.
 Forced draught cooling system with hermetically sealed compressor.
 Copper piping and aluminium flaps evaporator.
 Digital display for electronic and digital control of temperature and defrosting.
 Opened door delay alarm.
 Self-closing and stay open doors. When opened less than 90° they close by themselves. When opened more than 135° they stay open.
 Built in drainage to get rid of waste liquids inside the unit.
 Embedded bottom and curved panels inside for easy cleaning and maintenance.
 Removable plastic covered steel grid shelves for easy cleaning.
 Equipment: 3 shelves per large door.
 Height adjustable stainless steel legs.
 Models with two storage temperatures and independent refrigeration systems.
 Working temperature: from -2 °C to +8 °C (refrigerators) and from -4 °C to -1 °C (fish compartment).
 A compartment fitted with three sanitary PVC drawers with perforated steel double bottom. The compartment includes an independent hermetically sealed ventilated compressor.
 Climatic class 4.
 Inner LED lights with power switch.

Doors: 2+1 fish compartment
 Energy efficiency: D
 Net capacity: 656 L
 Gross capacity: 1301 L
 Cooling power: 357+176 W
 Electric power: 186+209 W
 Annual energy consumption: 906 kWh/year
 Coolant: R-600a+R-290
 Dimensions: 1388x826x2008 mm





Catalogue :
CABINETS GLOBE

Chapter :
GLOBE CONCEPT GN CABINETS

Article :
EAF-1603 P 230V 1N 50Hz

Code :
19038531

SCHEMA - DIMENSIONS

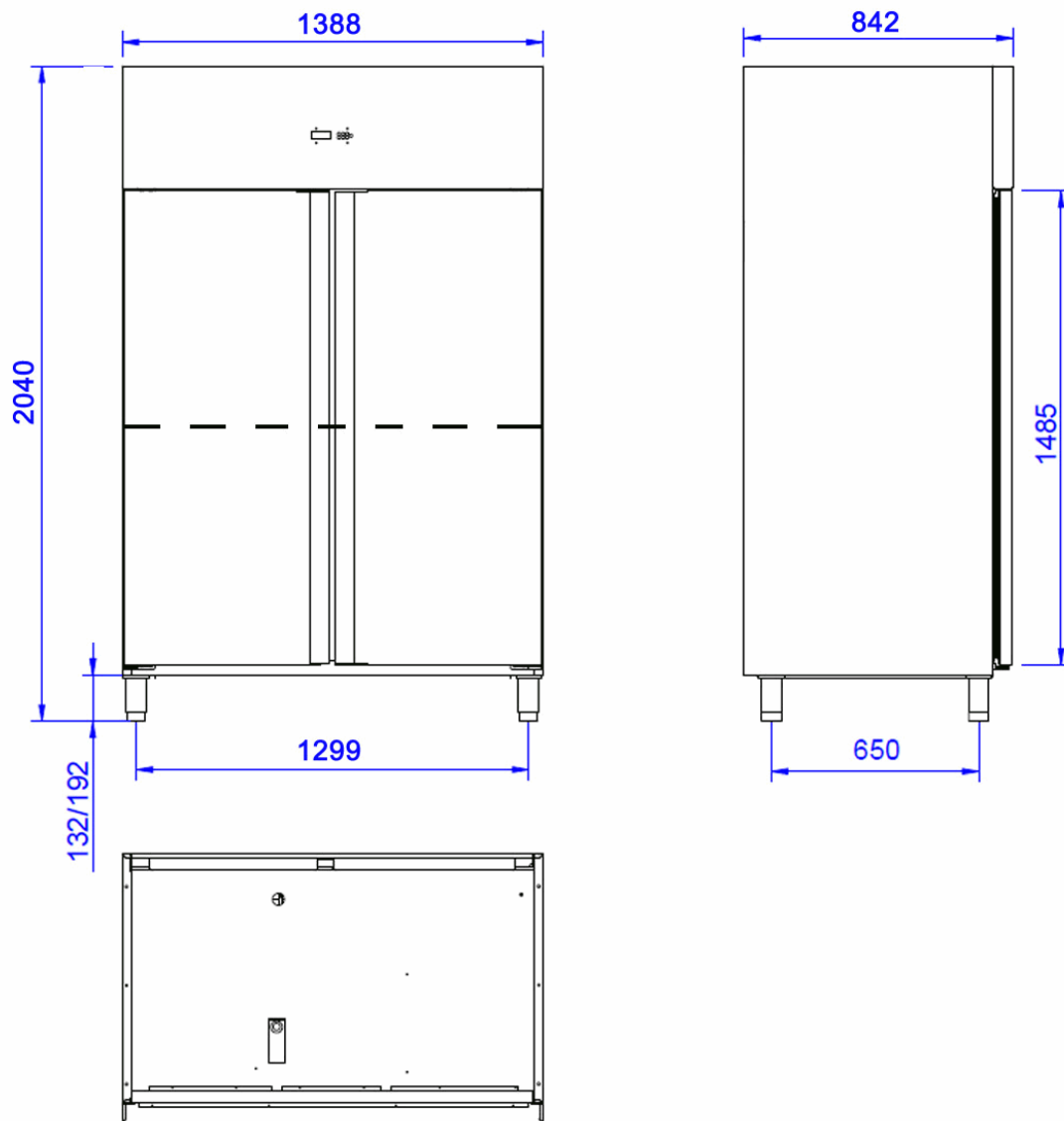



Catalogue :

CABINETS GLOBE

Chapter :

GLOBE CONCEPT GN CABINETS

Article :

EAF-1604 P 230V 1N 50Hz

Code:

19038532

<u>DIMENSIONS AND WEIGHTS</u>		<u>Net dimensions</u>	<u>Packed</u>
Length	mm	1.388,00	860,00
Depth	mm	826,00	1.430,00
Height	mm	2.008,00	2.027,00
Weight	kg	264,00	269,00
Volume	m3	2,30	2,49
<u>ELECTRICITY</u>		50Hz	
	Power		0,19 kW
Connections	230 V. 1+N+T	2X1,5+T - 4 A	
	230 V. III+T		
	400 V. III+N+T	2X(4X6MM2+T)	
<u>GAS</u>	Not necessary		
<u>WATER</u>	Not necessary		
<u>STEAM</u>	Not necessary		
<u>AIR</u>	Not necessary		
	Refrigeration power		0,360
	Consumption - kW-h	365 d.	906
		24 h	2,48
	Net volume - litres	Refrig.	656
	Internal gross capacity	litres	1.301
	Climat class	4	Energy Effic. D
<u>SOUND LEVEL</u>			< 65,00 db
<u>CERTIFICATES</u>	SGS-2103-0906-1		
<u>INSTALLATION - CONNECTIONS</u>			Ø
	► ELECTRICITY		SI

DESCRIPTION

REFRIGERATION CABINET WITH FISH COMPARTMENT GASTRONORM, EAF-1604 P

SPECIFICATIONS

High quality austenitic stainless steel inside and outside (except for galvanized back panel).
 60 mm, 40 kg/m3 injected polyurethane isolation.
 Embedded inner tray slides. Storage trays at 23 different levels 55 mm from each other.
 Forced draught cooling system with hermetically sealed compressor.
 Copper piping and aluminium flaps evaporator.
 Digital display for electronic and digital control of temperature and defrosting.
 Opened door delay alarm.
 Self-closing and stay open doors. When opened less than 90° they close by themselves. When opened more than 135° they stay open.
 Built in drainage to get rid of waste liquids inside the unit.
 Embedded bottom and curved panels inside for easy cleaning and maintenance.
 Removable plastic covered steel grid shelves for easy cleaning.
 Equipment: 3 shelves per large door.
 Height adjustable stainless steel legs.
 Models with two storage temperatures and independent refrigeration systems.
 Working temperature: from -2 °C to +8 °C (refrigerators) and from -4 °C to -1 °C (fish compartment).
 A compartment fitted with three sanitary PVC drawers with perforated steel double bottom. The compartment includes an independent hermetically sealed ventilated compressor.
 Climatic class 4.
 Inner LED lights with power switch.

Doors: 3+1 fish compartment
 Energy efficiency: D
 Net capacity: 656 L
 Gross capacity: 1301 L
 Cooling power: 357+176 W
 Electric power: 186+209 W
 Annual energy consumption: 906 kWh/year
 Coolant: R-600a+R-290
 Dimensions: 1388x826x2008 mm





Catalogue :
CABINETS GLOBE

Chapter :
GLOBE CONCEPT GN CABINETS

Article :
EAF-1604 P 230V 1N 50Hz

Code :
19038532

SCHEMA - DIMENSIONS

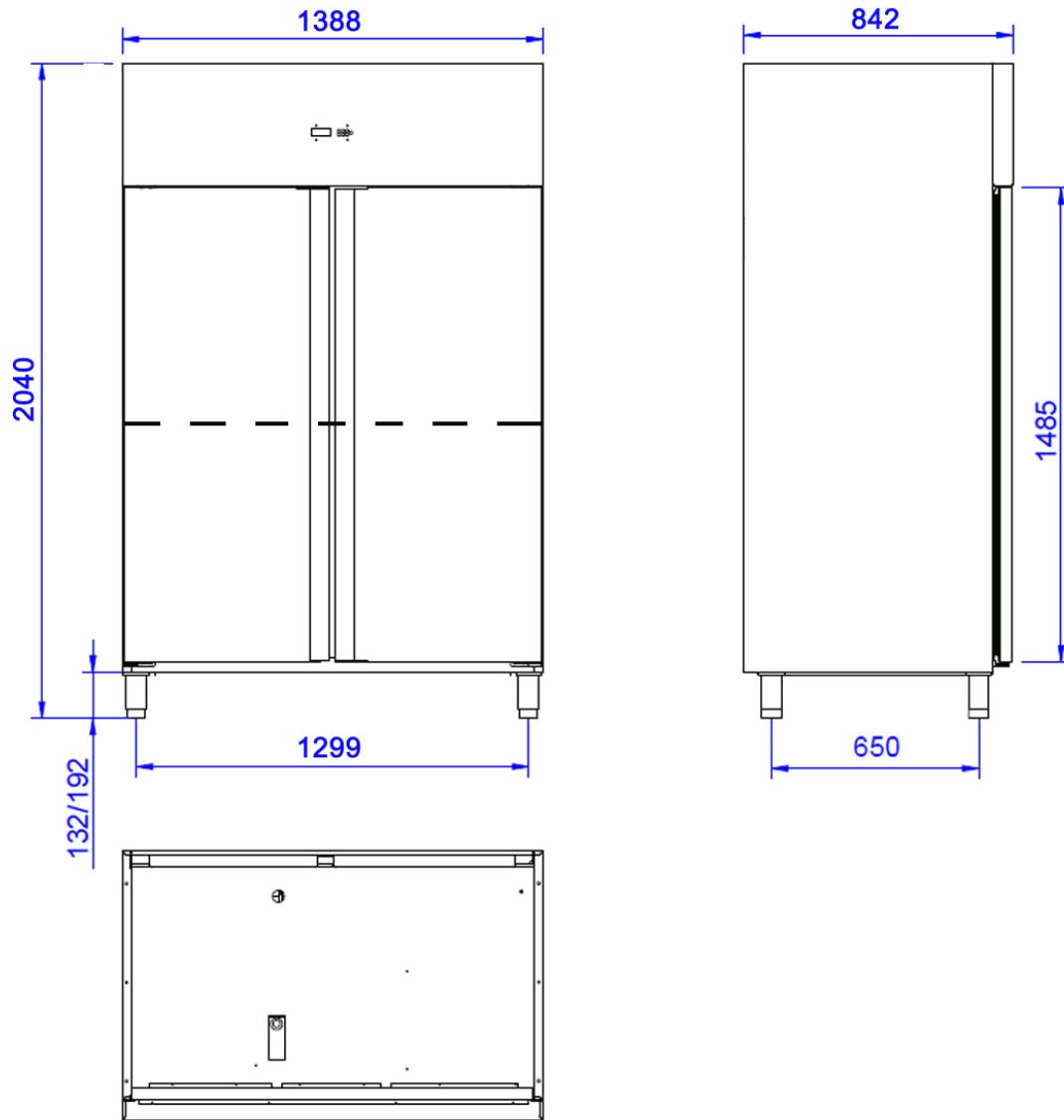



Catalogue :

CABINETS GLOBE

Chapter :

GLOBE CONCEPT GN CABINETS

Article :

EAFP-802/2 230V 1N 50Hz

Code:

19042469

<u>DIMENSIONS AND WEIGHTS</u>		<u>Net dimensions</u>	<u>Packed</u>
Length	mm	693,00	860,00
Depth	mm	826,00	730,00
Height	mm	2.008,00	2.027,00
Weight	kg	190,00	195,00
Volume	m3	1,15	1,27
<u>ELECTRICITY</u>		50Hz	
	Power		0,22 kW
Connections	230 V. 1+N+T	2X1,5+T - 4 A	
	230 V. III+T		
	400 V. III+N+T	4X1,5 +T - 12 A	
<u>GAS</u>	Not necessary		
<u>WATER</u>	Not necessary		
<u>STEAM</u>	Not necessary		
<u>AIR</u>	Not necessary		
			R-600a
	Refrigeration power		0,352
	Consumption - kW-h	365 d.	679
		24 h	1,86
	Net volume - litres	Refrig.	218
	Internal gross capacity	litres	596
	Climat class	4	Energy Effic. D
<u>SOUND LEVEL</u>			< 65,00 db
<u>CERTIFICATES</u>	SGS-2103-0906-1		
<u>INSTALLATION - CONNECTIONS</u>			Ø
	▶ ELECTRICITY		SI

DESCRIPTION

DUAL TEMPERATURE CABINET GASTRONORM, EAFP-802/2

SPECIFICATIONS

High quality austenitic stainless steel inside and outside (except for galvanized back panel).
 60 mm, 40 kg/m3 injected polyurethane isolation.
 Embedded inner tray slides. Storage trays at 23 different levels 55 mm from each other.
 Forced draught cooling system with hermetically sealed compressor. Copper piping and aluminium flaps evaporator.
 Digital display for electronic and digital control of temperature and defrosting.
 Opened door delay alarm.
 Self-closing and stay open doors. When opened less than 90° they close by themselves. When opened more than 135° they stay open.
 Built in drainage to get rid of waste liquids inside the unit.
 Embedded bottom and curved panels inside for easy cleaning and maintenance.
 Removable plastic covered steel grid shelves for easy cleaning.
 Equipment: 3 shelves per large door.
 Height adjustable stainless steel legs.
 Models with two storage temperatures and independent refrigeration systems.
 Working temperature: from -2 °C to +8 °C (refrigerators) and from -18 °C to -22 °C (freezers).
 Climatic class 4.
 Inner LED lights with power switch.

Doors: 1+1
 Energy efficiency: D
 Net capacity: 218 L
 Gross capacity: 596 L
 Cooling power: 176+176 W
 Electric power: 216+216 W
 Annual energy consumption: 679 kWh/year
 Coolant: R-600a
 Dimensions: 693x826x2008 mm





Catalogue :
CABINETS GLOBE

Chapter :
GLOBE CONCEPT GN CABINETS

Article :
EAFP-802/2 230V 1N 50Hz

Code :
19042469

SCHEMA - DIMENSIONS

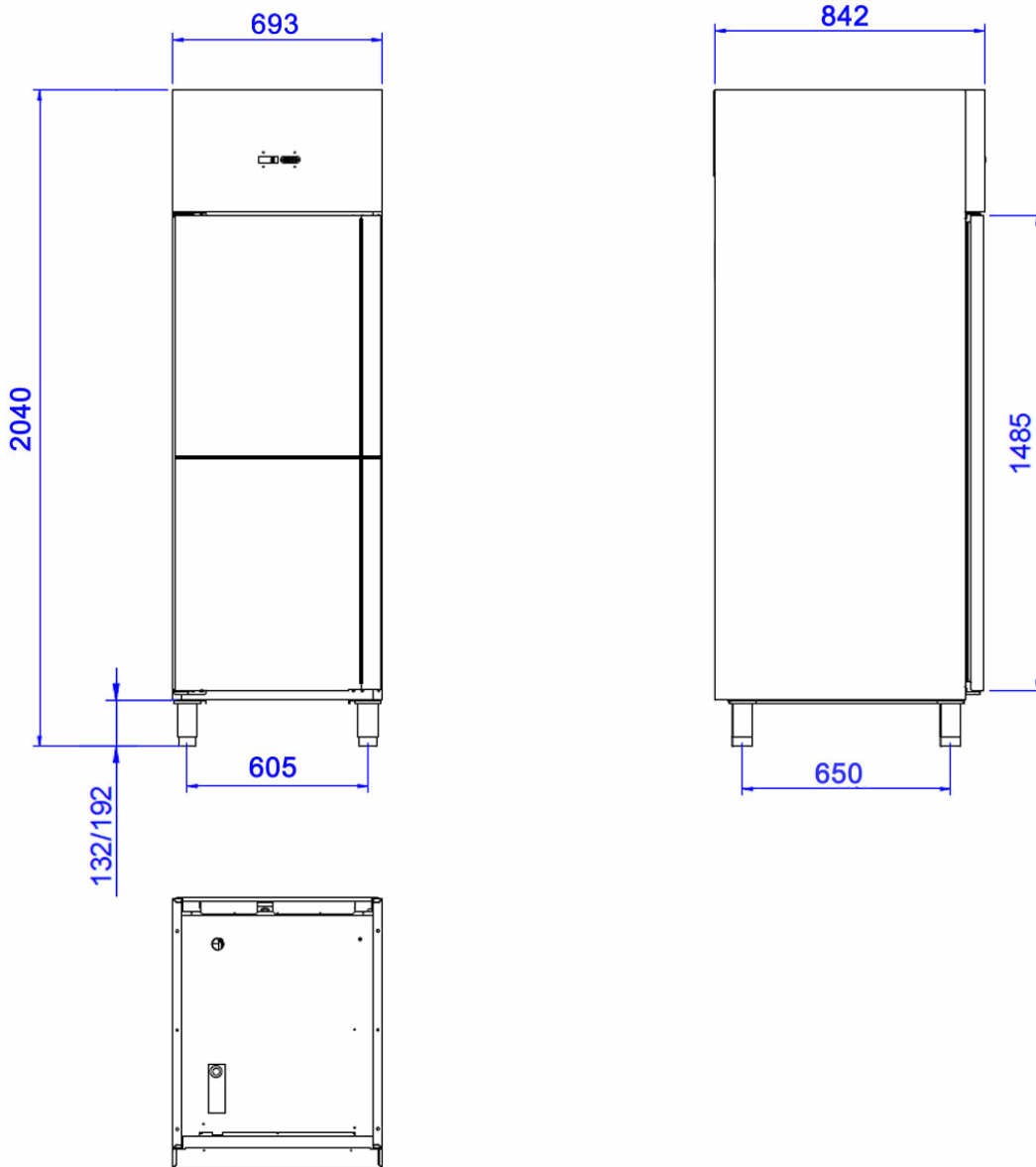



Catalogue :

CABINETS GLOBE

Chapter :

GLOBE CONCEPT GN CABINETS

Article :

EAFP-1603/2 230V 1N 50Hz

Code:

19042470

<u>DIMENSIONS AND WEIGHTS</u>		<u>Net dimensions</u>	<u>Packed</u>
Length	mm	1.388,00	860,00
Depth	mm	826,00	1.430,00
Height	mm	2.008,00	2.027,00
Weight	kg	270,00	275,00
Volume	m3	2,30	2,49
<u>ELECTRICITY</u>		50Hz	
	Power		0,16 kW
Connections	230 V. 1+N+T	2X1,5+T - 4 A	
	230 V. III+T		
	400 V. III+N+T	4X1,5 +T - 12 A	
<u>GAS</u>	Not necessary		
<u>WATER</u>	Not necessary		
<u>STEAM</u>	Not necessary		
<u>AIR</u>	Not necessary		
			R-600a
	Refrigeration power		0,618
	Consumption - kW-h	365 d.	905
		24 h	2,48
	Net volume - litres	Refrig.	437
	Internal gross capacity	litres	1.301
	Climat class	4	Energy Effic. D
<u>SOUND LEVEL</u>			< 65,00 db
<u>CERTIFICATES</u>	SGS-2103-0906-1		
<u>INSTALLATION - CONNECTIONS</u>			Ø
	► ELECTRICITY		SI

DESCRIPTION

DUAL TEMPERATURE CABINET GASTRONORM, EAFP-1603/2

SPECIFICATIONS

High quality austenitic stainless steel inside and outside (except for galvanized back panel).
 60 mm, 40 kg/m3 injected polyurethane isolation.
 Embedded inner tray slides. Storage trays at 23 different levels 55 mm from each other.
 Forced draught cooling system with hermetically sealed compressor. Copper piping and aluminium flaps evaporator.
 Digital display for electronic and digital control of temperature and defrosting.
 Opened door delay alarm.
 Self-closing and stay open doors. When opened less than 90° they close by themselves. When opened more than 135° they stay open.
 Built in drainage to get rid of waste liquids inside the unit.
 Embedded bottom and curved panels inside for easy cleaning and maintenance.
 Removable plastic covered steel grid shelves for easy cleaning.
 Equipment: 3 shelves per large door.
 Height adjustable stainless steel legs.
 Models with two storage temperatures and independent refrigeration systems.
 Working temperature: from -2 °C to +8 °C (refrigerators) and from -18 °C to -22 °C (freezers).
 Climatic class 4.
 Inner LED lights with power switch.

Doors: 2+1
 Energy efficiency: D
 Net capacity: 437 L
 Gross capacity: 1301 L
 Cooling power: 309+309 W
 Electric power: 158+158 W
 Annual energy consumption: 905 kWh/year
 Coolant: R-600a
 Dimensions: 1388x826x2008 mm





Catalogue :
CABINETS GLOBE

Chapter :
GLOBE CONCEPT GN CABINETS

Article :
EAFP-1603/2 230V 1N 50Hz

Code :
19042470

SCHEMA - DIMENSIONS

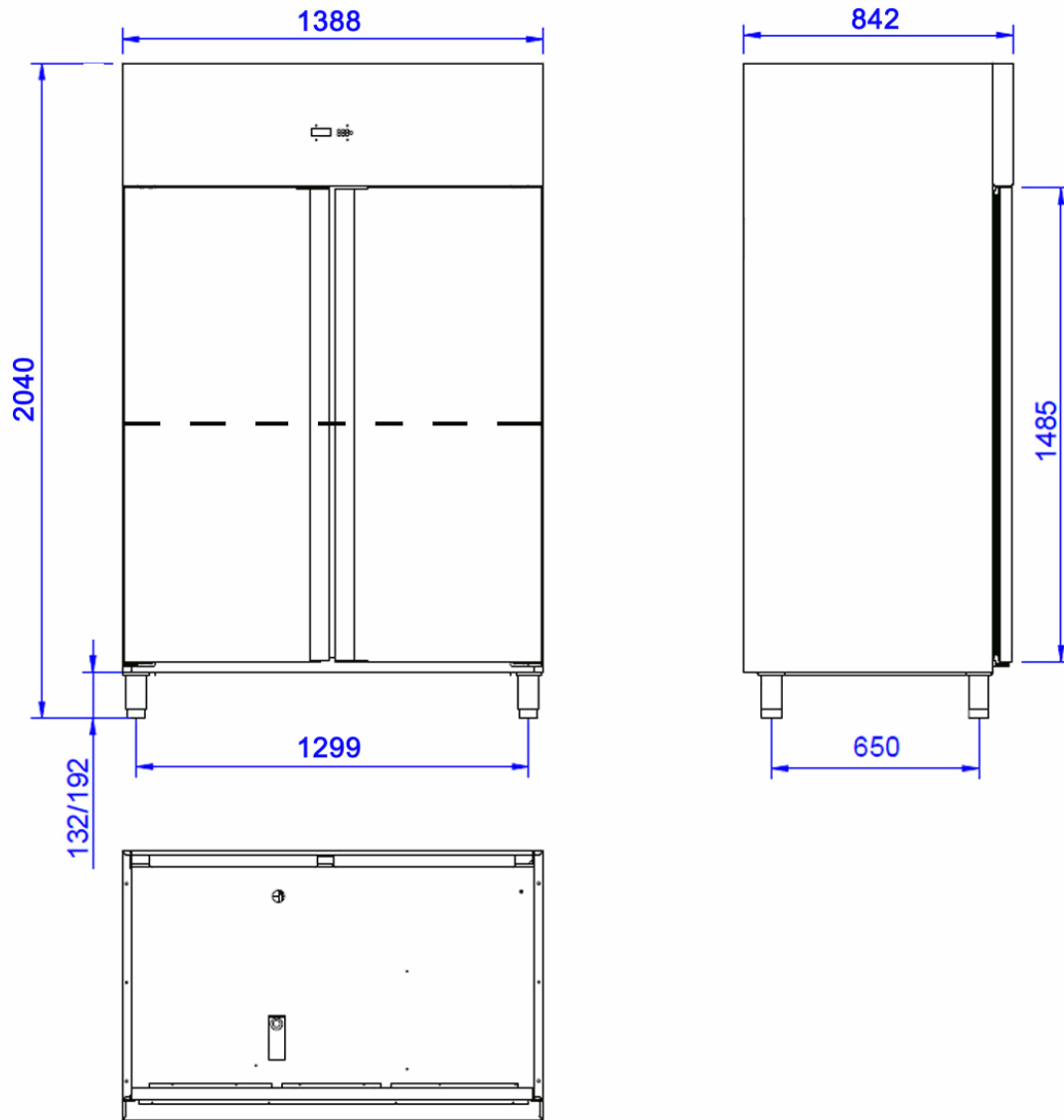



Catalogue :

CABINETS GLOBE

Chapter :

GLOBE CONCEPT GN CABINETS

Article :

EAFP-1604/2 230V 1N 50Hz

Code:

19042471

<u>DIMENSIONS AND WEIGHTS</u>		<u>Net dimensions</u>	<u>Packed</u>
Length	mm	1.388,00	860,00
Depth	mm	826,00	1.430,00
Height	mm	2.008,00	2.027,00
Weight	kg	270,00	275,00
Volume	m3	2,30	2,49
<u>ELECTRICITY</u>		50Hz	
	Power		0,16 kW
Connections	230 V. 1+N+T	2X1,5+T - 4 A	
	230 V. III+T		
	400 V. III+N+T	4X1,5 +T - 12 A	
<u>GAS</u>	Not necessary		
<u>WATER</u>	Not necessary		
<u>STEAM</u>	Not necessary		
<u>AIR</u>	Not necessary		
			R-600a
	Refrigeration power		0,618
	Consumption - kW-h	365 d.	905
		24 h	2,48
	Net volume - litres	Refrig.	437
	Internal gross capacity	litres	1.301
	Climat class	4	Energy Effic. D
<u>SOUND LEVEL</u>			< 65,00 db
<u>CERTIFICATES</u>	SGS-2103-0906-1		
<u>INSTALLATION - CONNECTIONS</u>			Ø
	► ELECTRICITY		SI

DESCRIPTION

DUAL TEMPERATURE CABINET GASTRONORM, EAFP-1604/2

SPECIFICATIONS

High quality austenitic stainless steel inside and outside (except for galvanized back panel).
 60 mm, 40 kg/m3 injected polyurethane isolation.
 Embedded inner tray slides. Storage trays at 23 different levels 55 mm from each other.
 Forced draught cooling system with hermetically sealed compressor. Copper piping and aluminium flaps evaporator.
 Digital display for electronic and digital control of temperature and defrosting.
 Opened door delay alarm.
 Self-closing and stay open doors. When opened less than 90° they close by themselves. When opened more than 135° they stay open.
 Built in drainage to get rid of waste liquids inside the unit.
 Embedded bottom and curved panels inside for easy cleaning and maintenance.
 Removable plastic covered steel grid shelves for easy cleaning.
 Equipment: 3 shelves per large door.
 Height adjustable stainless steel legs.
 Models with two storage temperatures and independent refrigeration systems.
 Working temperature: from -2 °C to +8 °C (refrigerators) and from -18 °C to -22 °C (freezers).
 Climatic class 4.
 Inner LED lights with power switch.

Doors: 3+1
 Energy efficiency: D
 Net capacity: 437 L
 Gross capacity: 1301 L
 Cooling power: 309+309 W
 Electric power: 158+158 W
 Annual energy consumption: 905 kWh/year
 Coolant: R-600a
 Dimensions: 1388x826x2008 mm





Catalogue :
CABINETS GLOBE

Chapter :
GLOBE CONCEPT GN CABINETS

Article :
EAFP-1604/2 230V 1N 50Hz

Code :
19042471

SCHEMA - DIMENSIONS

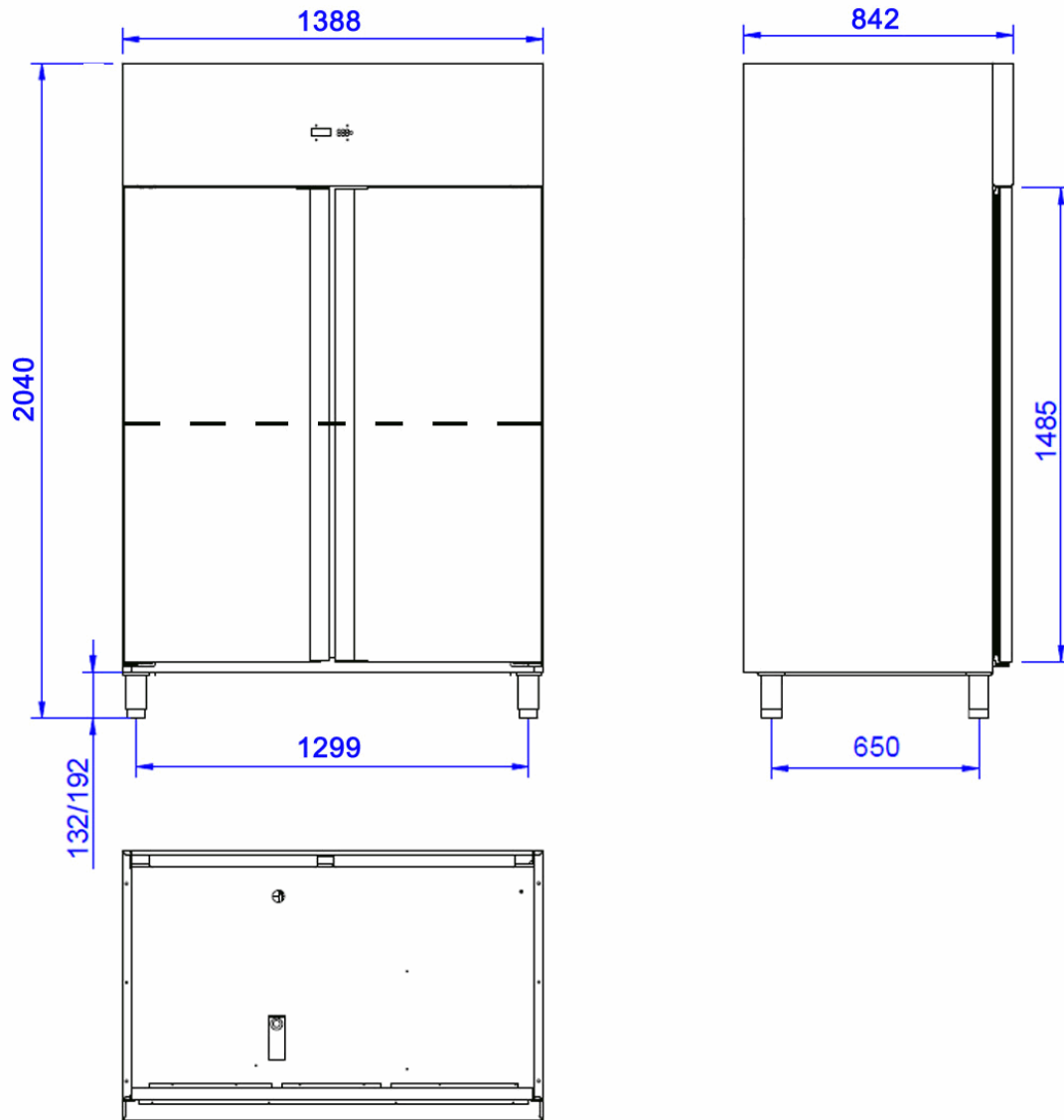



Catalogue :

CABINETS GLOBE

Chapter :

GLOBE CONCEPT GN CABINETS

Article :

EAFP-1602/2 230V 1N 50Hz

Code:

19042473

<u>DIMENSIONS AND WEIGHTS</u>		<u>Net dimensions</u>	<u>Packed</u>
Length	mm	1.388,00	860,00
Depth	mm	826,00	1.430,00
Height	mm	2.008,00	2.027,00
Weight	kg	270,00	275,00
Volume	m3	2,30	2,49
<u>ELECTRICITY</u>		50Hz	
	Power		0,16 kW
Connections	230 V. 1+N+T	2X1,5+T - 4 A	
	230 V. III+T		
	400 V. III+N+T	4X1,5 +T - 12 A	
<u>GAS</u>	Not necessary		
<u>WATER</u>	Not necessary		
<u>STEAM</u>	Not necessary		
<u>AIR</u>	Not necessary		
			R-600a
	Refrigeration power		0,618
	Consumption - kW-h	365 d.	905
		24 h	2,48
	Net volume - litres	Refrig.	437
	Internal gross capacity	litres	1.301
	Climat class	4	Energy Effic. D
<u>SOUND LEVEL</u>			< 65,00 db
<u>CERTIFICATES</u>	SGS-2103-0906-1		
<u>INSTALLATION - CONNECTIONS</u>			Ø
	► ELECTRICITY		SI

DESCRIPTION

DUAL TEMPERATURE CABINET GASTRONORM, EAFP-1602/2

SPECIFICATIONS

High quality austenitic stainless steel inside and outside (except for galvanized back panel).
 60 mm, 40 kg/m3 injected polyurethane isolation.
 Embedded inner tray slides. Storage trays at 23 different levels 55 mm from each other.
 Forced draught cooling system with hermetically sealed compressor. Copper piping and aluminium flaps evaporator.
 Digital display for electronic and digital control of temperature and defrosting.
 Opened door delay alarm.
 Self-closing and stay open doors. When opened less than 90° they close by themselves. When opened more than 135° they stay open.
 Built in drainage to get rid of waste liquids inside the unit.
 Embedded bottom and curved panels inside for easy cleaning and maintenance.
 Removable plastic covered steel grid shelves for easy cleaning.
 Equipment: 3 shelves per large door.
 Height adjustable stainless steel legs.
 Models with two storage temperatures and independent refrigeration systems.
 Working temperature: from -2 °C to +8 °C (refrigerators) and from -18 °C to -22 °C (freezers).
 Climatic class 4.
 Inner LED lights with power switch.

Doors: 1+1
 Energy efficiency: D
 Net capacity: 437 L
 Gross capacity: 1301 L
 Cooling power: 309+309 W
 Electric power: 158+158 W
 Annual energy consumption: 905 kWh/year
 Coolant: R-600a
 Dimensions: 1388x826x2008 mm





Catalogue :
CABINETS GLOBE

Chapter :
GLOBE CONCEPT GN CABINETS

Article :
EAFP-1602/2 230V 1N 50Hz

Code :
19042473

SCHEMA - DIMENSIONS

